

## Battery Replacement

1. Remove smoke alarm from mounting plate following Step 1 of the installation instructions.
2. Clean the device as described in maintenance paragraph.
3. Replace the old batteries by a new pair. Use recommended batteries for more reliable operation.
4. Place the smoke alarm on the Mounting plate and secure it by turning it clockwise.
5. Test the correct operation of your smoke alarm as described in Device Test paragraph. If no sound is generated, the smoke alarm must be replaced immediately!

## Recycling and Desposal

The WEEE symbol means that this product and batteries must be disposed separately from other household waste. When they reach their end of life, take them to a designated waste collection point in your area to guarantee a safe disposal or recycling. Protect the environment, human health and natural resources!

## Troubleshooting

False alarm is often caused by dust or steam.

After a batteries replacement, the device performs an auto-adjusting process in 8 hours period to establish its operation. If false alarm happens within this period, it is important to clean the smoke alarm as described in maintenance paragraph.

## Technical Characteristics

BS-506/LITHIUM	
POWER SUPPLY	Replaceable batteries: 2x AA Lithium FR6 (L91)
BATTERY LIFE	10 years
SMOKE CONCENTRATION SENSITIVITY	0.110 dB/m
INDICATORS	Optical and Acoustic > 85dB (A) at 3 m
ALARM SILENCE FACILITY	Yes
LOW BATTERY WARNING	Yes
LOW BATTERY SILENCE FACILITY	Yes
MOUNTING LOCATION	Ceiling
INTERCONNECTABLE	No
DETECTION METHOD	Optical
DEGREES OF COVER PROTECTION	IP20
PRODUCED IN ACCORDANCE WITH	EN14604-2005
OPERATION TEMPERATURE RANGE	0 to 45 °C
RELATIVE HUMIDITY	Up to 93%
CONSTRUCTION MATERIAL	ABS/PC, PC
EXTERNAL DIMENSION	Ø130 x 43 mm
WEIGHT	185gr.
GUARANTEE	3 years (1 year for the battery)

## Signaling Overview

Operating Mode	Visible indication (flashes)	Acoustic Signal	Comment
NORMAL	1 Red per 344 sec	None	Device functioning properly
TEST	1 Red per sec	Alarm pattern	Device under test
ALARM	1 Red per sec	Alarm Pattern	Smoke detected
HUSH	1 Red per 10 sec	None	9 min decreased sensitivity
ALARM MEMORY	3 Yellow per 43 sec	None	Exited an alarm mode
LOW BATTERY	None	1 short signal per 43 sec	Replace batteries
FAULT WARNING	None	3 short signals per 43 sec	Replace the smoke detector

<b>BS-506/LITHIUM</b> Battery Operated Smoke Detector	<b>CE</b> 1922
EN 14604:2005 DoP: 921506001_59_001	21
 olympia-electronics SAFETY & SECURITY SYSTEMS <i>for a safer world</i>	<b>EGINIO</b> <b>PIERIAS</b> <b>60300</b> <b>GREECE</b>

## Warranty

Olympia Electronics guarantees the quality, condition and operation of the goods. The period of warranty is specified in the official catalogue of Olympia Electronics and also in the technical leaflet, which accompanies each product. This warranty ceases to exist if the buyer does not follow the technical instructions included in official documents given by Olympia Electronics or if the buyer modifies the goods provided or has any repairs or re-setting done by a third party, unless Olympia Electronics has fully agreed to them in writing. Products that have been damaged can be returned to the premises of our company for repair or replacement, as long as the warranty period is valid.

Olympia Electronics reserves the right to repair or to replace the returned goods and to or not charge the buyer depending on the reason of deflection. Olympia Electronics reserves the right to charge or not the buyer the transportation cost.



72nd km. O.N.R. Thessaloniki-Katerini  
P.C. 60300 P.O. Box 06 Eginio Pierias Greece

[www.olympia-electronics.com](http://www.olympia-electronics.com)  
[info@olympia-electronics.gr](mailto:info@olympia-electronics.gr)



## BS-506/LITHIUM BATTERY OPERATED SMOKE DETECTOR



Thank you for your trust in our products  
Olympia Electronics - European manufacturer

## Package Contents

1	Smoke detector
2	AA Batteries (installed)
1	Mounting accessories
1	Manual

## General

The BS-506 is a battery operated smoke detector with an optical sensor for installation in residential buildings, apartments and rooms. Smoke alarms are designed to provide an early warning of fire events giving enough time for people to evacuate the building/room. Always consult local regulations for smoke alarms.

### CAUTION!!

- To prevent injury, the device must be securely attached to the ceiling in accordance with the installation instructions.
- Batteries should be protected from excessive heat, such as direct light beams or fire.
- Do not paint or cover the smoke alarm.
- Do not install the detector in direct sunlight. Keep at least 0.5m from light sources.
- Consult the manufacturer's advice if the device doesn't work properly.
- Due to the loudness of the alarm, make sure that you always stand at arm's length distance from the unit when you are testing.
- Do not install the detector close to ventilation points.
- Do not install the detector in leisure accommodation vehicles
- Do not charge batteries
- Do not mix new and used batteries or batteries of different types or brands
- Exhausted batteries should be immediately removed from equipment and properly disposed of
- Do not dismantle batteries
- Do not deform batteries
- A lithium battery with a damaged container should not be exposed to water
- Store unused batteries in their original packaging away from metal objects. If already unpacked, do not mix or jumble batteries
- Replace all batteries of a set at the same time.
- Clean the battery contacts and also those of the equipment prior to battery installation
- Ensure that the batteries are installed correctly with regard to polarity (+ and -)
- Remove exhausted batteries promptly

### DEVICE TEST

A Device Test is performed when the TEST button is pressed for more than 1 second. If the device works properly it will produce a loud alarm sound. When the TEST button is released, the alarm sound will stop and the device enters the Hush mode. After a time of 9 minutes returns to normal (stand by) operation.

### LOW BATTERY MODE

If the battery's level is low, the horn will sound as a short pulse every 43 seconds which continues until the batteries are replaced. If a low battery condition exists, a Low Battery Hush mode can be selected by pressing the TEST button, the Red LED will turn on to indicate the low battery condition. After the TEST button is released, the unit enters Low Battery Hush mode and the device is silenced for 8 hours. At the end of the 8 hours, the audible indication will resume. The activation of the TEST button will also initiate the 9 minutes Hush mode.

### HUSH

When the device is in Alarm condition, every Device Test will initiate the Hush mode. When Hush mode is started, the unit immediately resets out of Alarm

condition and the horn is silenced. The Hush mode duration is 9 minutes and the Red LED flashes faster, after this period expires, the unit goes back to its normal operation. During Hush mode, the device's sensitivity is reduced and a higher Smoke concentration is needed, to place the unit again into an Alarm condition. Also, Hush mode can be canceled from the user by performing a New Device Test.

### ALARM MEMORY

The Alarm Memory allows easy identification of any unit that had previously been in Alarm. When a detector exits an Alarm condition, the Yellow LED flashes three times and this pattern repeats every 43 seconds. This visual indication will stop after a period of 24 hours. The user will still be able to identify a unit that had previously been in Alarm, by pressing the TEST button, the horn will sound in short pulses and the Alarm memory resets. The initial 24 hour visual indication is not displayed when a low battery condition exists.

### FAULT WARNING

When the smoke alarm is not functioning properly, it will turn into the Fault warning mode and produces three short acoustic signals every 43 seconds. Try cleaning the smoke alarm (see paragraph maintenance) otherwise replace it!

## Installation instructions

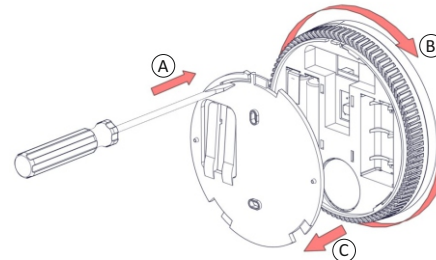

1

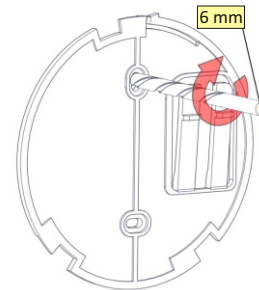

2

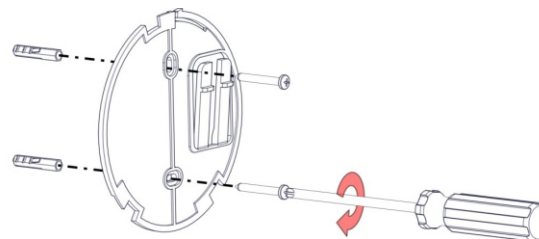

3

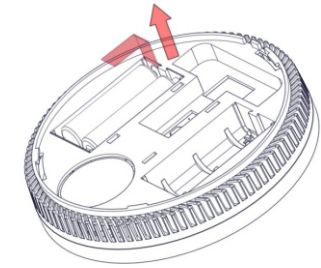

4

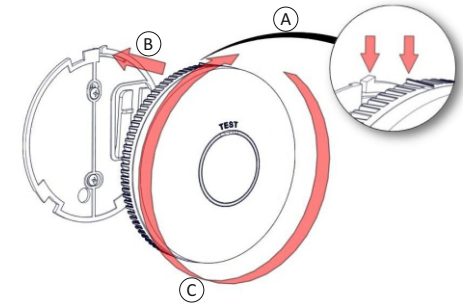

5

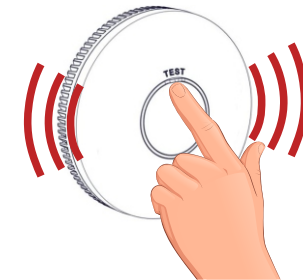

NOTE!!!

If no sound is generated, the smoke alarm is not functioning properly and should not be used!

6

## Maintenance

- Test the smoke alarm weekly for correct operation using the Device Test facility. If the smoke alarm functions correctly, it will generate a loud beep otherwise must be replaced immediately!
- Clean the smoke alarm once per month to remove dirt, dust or debris.
- Use a vacuum cleaner with a soft brush and vacuum all sides and covers of the smoke alarm. Do not remove the top cover of the smoke alarm to clean it inside.
- Do not attempt to repair this smoke alarm. If the smoke alarm shows a damage it must be replaced!
- In accordance with EN14604 standard, is recommended to replace the device after 10 years of operation.