

Package contents

- 1 CP-921 Button
- 1 BS-521/SB Siren Beacon
- 1 User manual
- 2 Mounting accessories

General

The SOS Alarm Emergency Button is an advanced notification system specifically designed to provide maximum safety and immediate response in emergency situations for individuals with disabilities (PWD).

How it works: The system is equipped with a cord that the user pulls in case assistance is needed. When the cord is pulled, an immediate audible alarm is activated, which is placed outside the restroom, notifying staff or passersby of the emergency. Additionally, the system has an internal battery, ensuring that the alarm will continue to sound even in the event of a power outage, providing continuous safety. There is also a reset switch, which can cancel the alarm.

Installation Instructions

BS-521/SB Siren Beacon

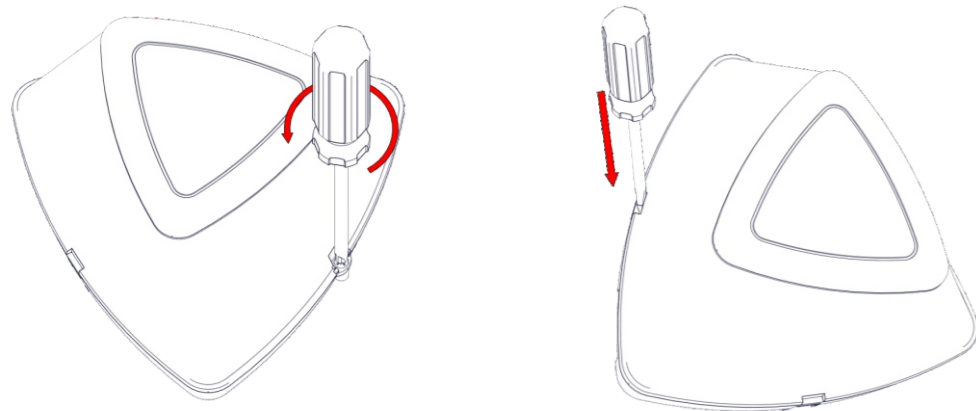

To disassemble the siren, start by unscrewing the screw, then use a flat screwdriver to release the retaining clips.

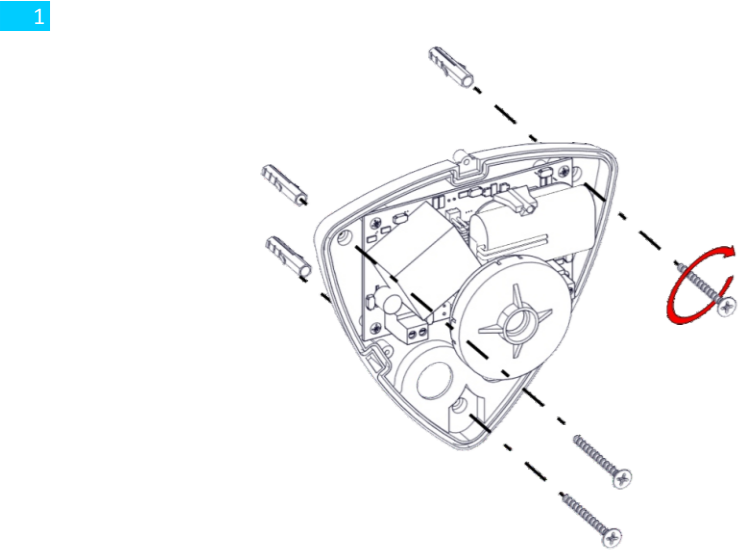

Secure the siren to the wall using the provided screws and wall plugs. Pay special attention to the correct orientation, according to the "UP" marking on the back of the siren.

2

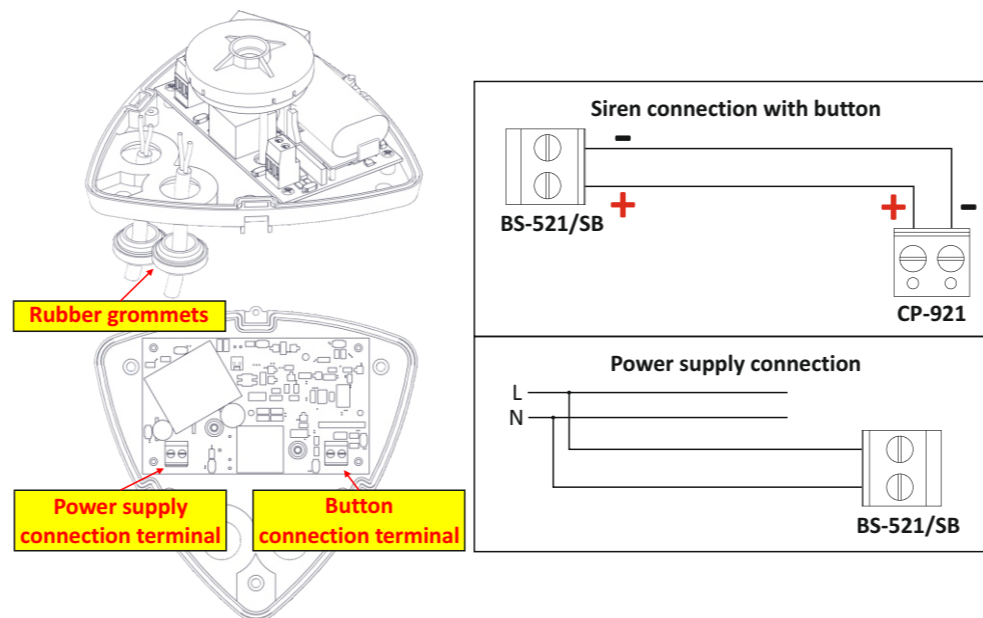

Install the provided rubber grommets. Pass the wires through the grommets and connect them according to the wiring diagrams.

3

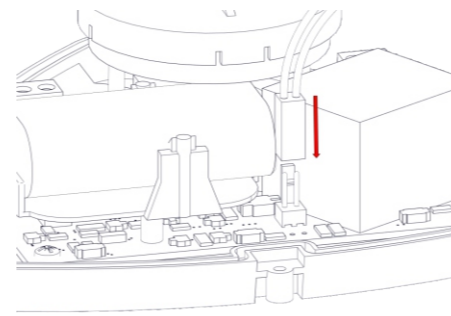

Connect the battery connector to the corresponding connector on the PCB.

WARNING! If the battery is connected before connecting the button, the siren will sound.

4



Place the siren cover, ensuring correct orientation. Press until the retaining clips are secured and screw in the screw that was removed in Step 1.

5

CP-921 Button

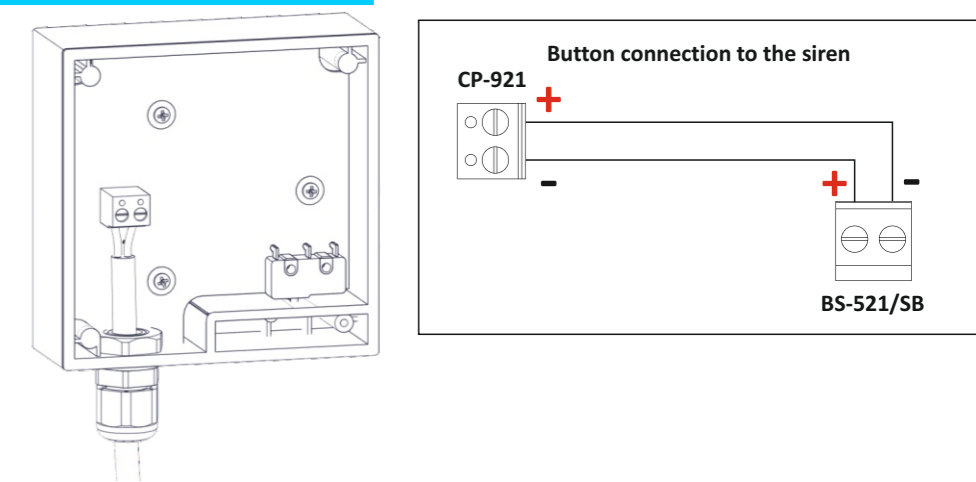

For the connection of the button to the siren, pass the cable you have already connected to the siren through the cable gland and connect it to the button terminal. Tighten the cable gland until full compression is achieved.

1

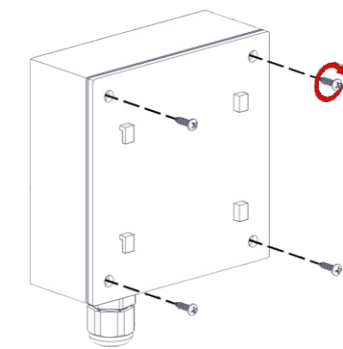

Place the cover on the button and screw it in with the four provided screws. Ensure that the sealing gasket is evenly applied to maintain the IP65 protection rating.

2

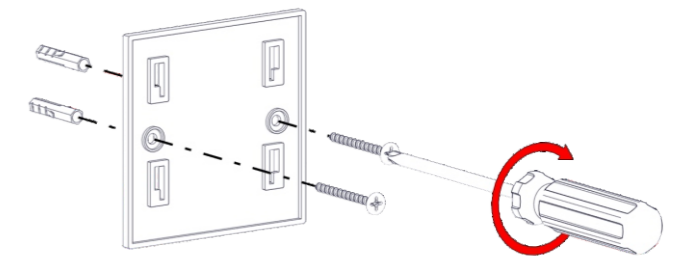

Secure the button base to the wall using the provided screws and wall plugs.

3

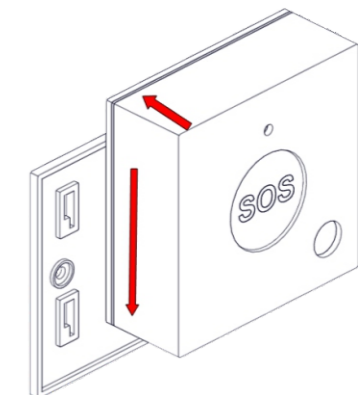

Place the button onto its base.

4

Dimensional drawings

CP-921 Button

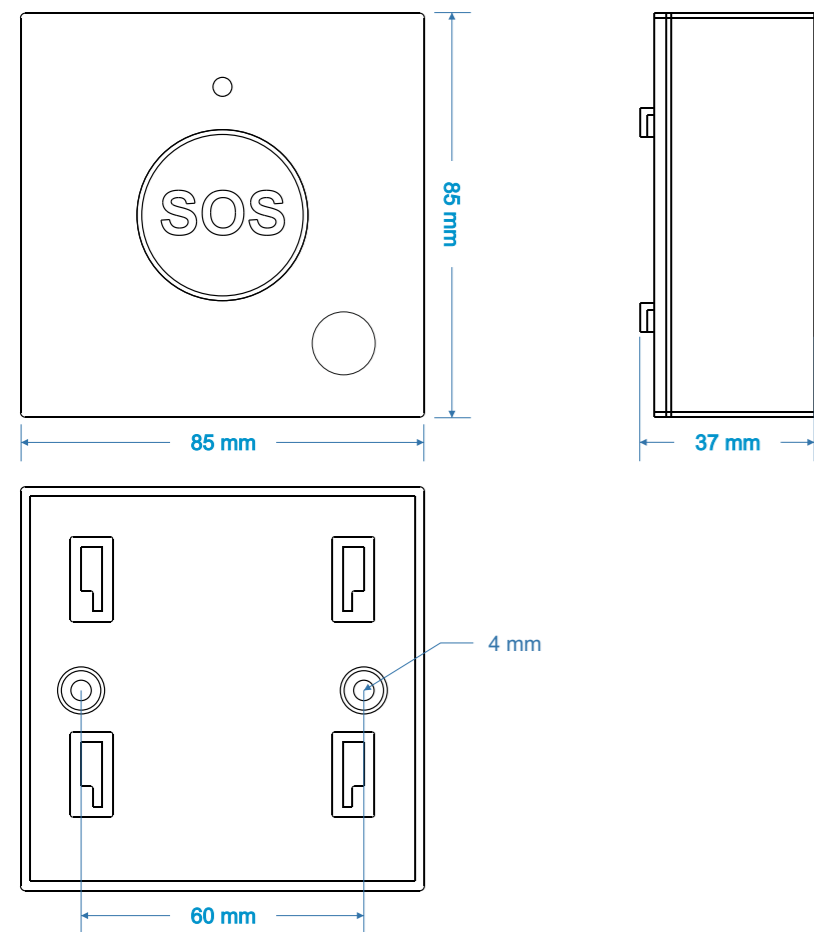

BS-521/SB Siren Beacon

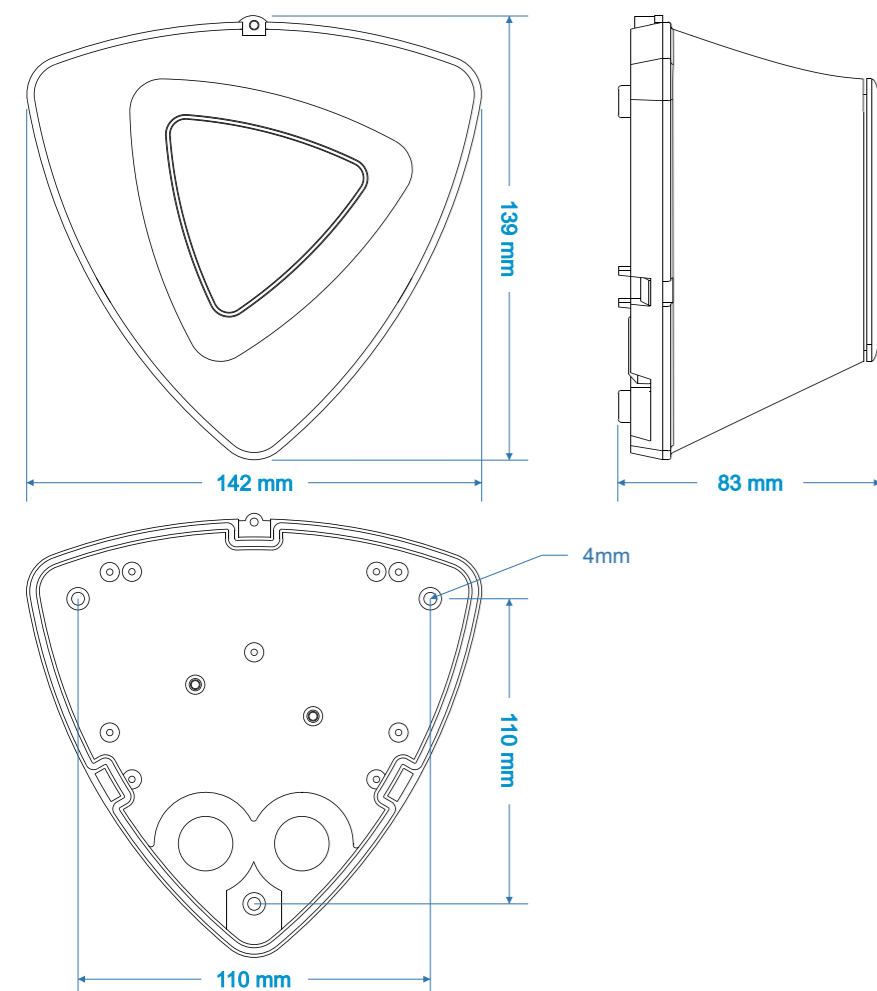

Technical Specifications

BS-521/SB	
OPERATING VOLTAGE	220-240V AC / 50-60Hz
MAXIMUM POWER CONSUMPTION	4VA
BATTERY (Ni-Cd)	2,4V / 1Ah
AUTONOMY	180 minutes
CHARGING TIME	24 hours
SOUND OUTPUT AT 1 METER	100 dB
LIGHT SOURCE	6 blue LED
ENCLOSURE PROTECTION RATING	IP42
PRODUCED ACCORDING TO	EN 50130-4, EN 55022, EN 60950-1
OPERATING TEMPERATURE RANGE	5 to 50 °C
RELATIVE HUMIDITY	Up to 95%
CONSTRUCTION MATERIALS	ABS, PC
EXTERNAL DIMENSIONS	142 x 139 x 83 mm
AVERAGE WEIGHT	340gr.
WARRANTY	2 years

CP-921	
OPERATING VOLTAGE	Powered by the BS-521/SB siren
MAXIMUM POWER CONSUMPTION	4VA
ENCLOSURE PROTECTION RATING	IP65
OPERATING TEMPERATURE RANGE	5 to 50 °C
RELATIVE HUMIDITY	Up to 95%
CONSTRUCTION MATERIALS	ABS, PC
EXTERNAL DIMENSIONS	85 x 85 x 37 mm
AVERAGE WEIGHT	120gr.
WARRANTY	2 years

Warranty



72nd km. O.N.R. Thessaloniki-Katerini
P.C. 60300 P.O. Box 06 Eginio Pierias Greece
www.olympia-electronics.com
info@olympia-electronics.com

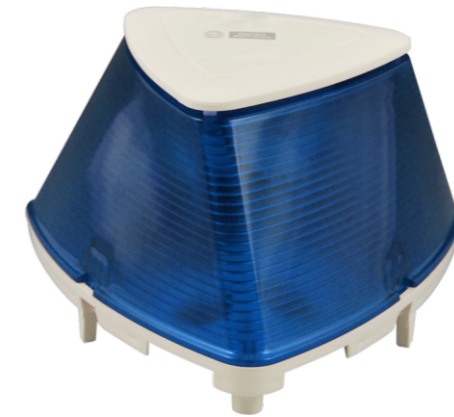

CP-920
EMERGENCY CALL SYSTEM FOR
ACCESSIBLE TOILETS (DISABLED ACCESS)

Thank you for your trust in our products
Olympia Electronics - European manufacturer