

WARRANTY

Olympia Electronics guarantees the quality, condition and operation of the goods. The period of warranty is specified in the official catalogue of Olympia Electronics and also in the technical leaflet, which accompanies each product. This warranty ceases to exist if the buyer does not follow the technical instructions included in official documents given by Olympia Electronics or if the buyer modifies the goods provided or has any repairs or re-setting done by a third party, unless Olympia Electronics has fully agreed to them in writing. Products that have been damaged can be returned to the premises of our company for repair or replacement, as long as the warranty period is valid.

Olympia Electronics reserves the right to repair or to replace the returned goods and to or not charge the buyer depending on the reason of defection. Olympia Electronics reserves the right to charge or not the buyer the transportation cost.

HEAD OFFICE

72nd km. O.N.R. Thessaloniki-Katerini
P.C. 60300 P.O. Box 06 Eginio Pierias Greece

www.olympia-electronics.gr

info@olympia-electronics.gr



EDGE ILLUMINATION SIGNS FOR CBS 24V DC



TECHNICAL CHARACTERISTICS (for LED MODULE Specifications see page 3)

	ZLD-28/CBS/24VDC/EM	ZLD-34/CBS/24VDC/EM	ZLD-44/CBS/24VDC/EM
Mains voltage	15-30V DC		
Maximum power consumption	1.4 W	1.6 W	1.85 W
Light source intensity	150lm	175lm	200lm
Degrees of cover protection	IP 40		
Produced in accordance with	EN 60598-1, EN 60598-2-22, EN 55015, EN 61547		
Operation temperature range	-30 to 50 °C		
Relative humidity	up to 95%		
Construction materials	Aluminum, Acrylic plate		
External dimensions	290x172x38mm	350x242x38mm	450x295x38mm
Typical weight	630 gr.	1010 gr.	1415 gr.
Guarantee	3 years		

Thank you for your trust in our products Olympia Electronics - European manufacturer

General:

- Operations for installation, maintenance or testing must be done by authorized personnel only.
- The device must be connected **only** to the CBS with 24VDC output either in mains or emergency like GR-8500.

Installation

To install the illumination sign follow the installation instructions below.

NOTE: LED= Light Emitting Diode
LABELING EXPLANATION:
Z: Central supply
1: Maintained (*)
G: Internally illuminated safety sign

INSTALLATION INSTRUCTIONS

ELECTRICAL CONNECTIONS

- Dismantle the luminaire by pushing the lock/unlock button and slide the luminaire to the right and pull it down.
- Pass through the cables from the entry hole and connect them (*please respect the polarity*).
- Place upwards the luminaire and slide it to the left. The lock/unlock button appears indicating that the luminaire is securely installed.
- Power on the device.

FLAG MOUNTING INSTALLATION (optional)

Install the flag mounting base on the wall (page 2) and perform the respective steps of the electrical connections.

SURFACE MOUNTING ON A WALL (single sided)

Install the included bracket on the wall (page 2) and perform the respective steps of the electrical connections.

CEILING INSTALLATION

Install the mounting base on the ceiling (page 2) and perform the respective steps of the electrical connections.

HANGING INSTALLATION (optional)

Install the mounting base (tube) on the ceiling (page 3) and perform the respective steps of the electrical connections.

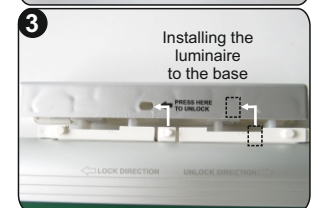
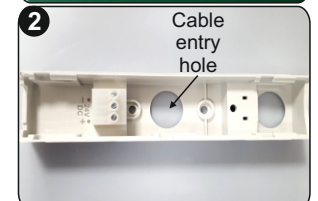

MOUNTING METHODS

FLAG MOUNTED ON A WALL

A-1133 SET
(OPTIONAL AFTER REQUEST)
only for ZLD-28/EM, ZLD-34/EM

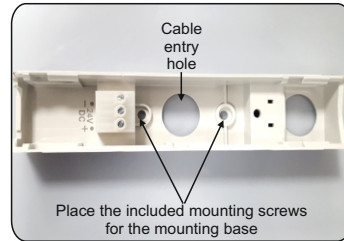
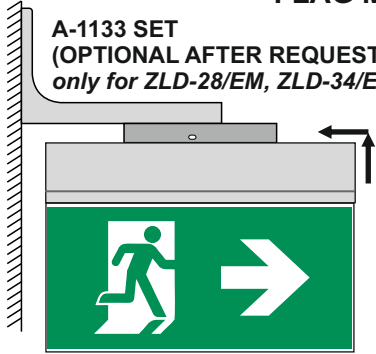

SURFACE MOUNTING ON A WALL (single side luminaire)

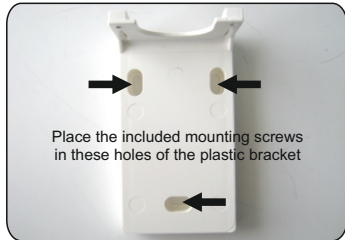

A-1134 SET
(INCLUDED IN THE PACKAGE)

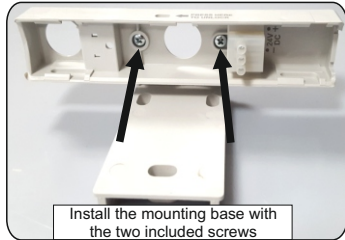
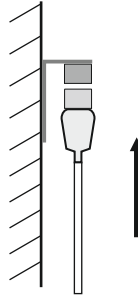

CEILING MOUNTED

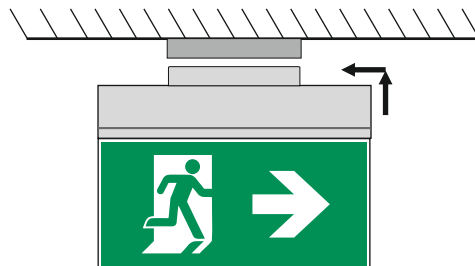
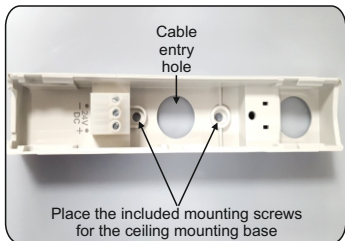

HANGING INSTALLATION

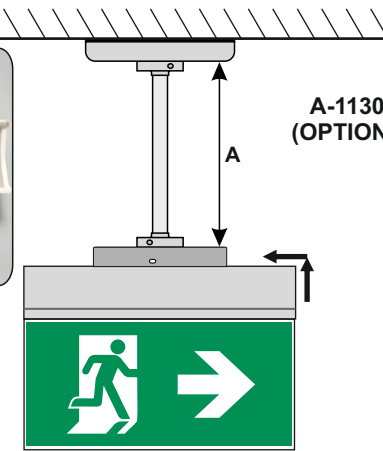
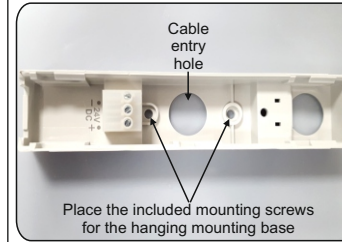

A-1130, A-1131, A-1132 SET
(OPTIONAL AFTER REQUEST)

	Tube
A-1130	A=1m
A-1131	A=0.5m
A-1132	A=0.25m

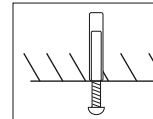

GENERAL!!

Measure the distance of the mounting holes and after the drilling place on these spots the mounting plugs and fasten the base with the mounting screws.



The light source contained in this luminaire shall only be replaced by the manufacturer, or his agent, or a similar qualified person.

NOTE! *The light source is non-user replaceable.*

LED MODULE CHARACTERISTICS

	ZLD-28/CBS/24VDC/EM	ZLD-34/CBS/24VDC/EM	ZLD-44/CBS/24VDC/EM
Manufacturer	Olympia Electronics S.A		
Model Number	1111153	1211153	3110123
Voltage Range	8.5-10.5 V DC		
Nominal Power	1200mW	1400mW	1600mW
Connections	Non reversible connection between main pcb and led module		
Temperature (tc)	45 °C max. across the board		