

ADDRESSABLE EDGE ILLUMINATION SIGN FOR GR-8600 CBS



TECHNICAL CHARACTERISTICS (for LED MODULE Specifications see page 3)

	ZLD-28/24V/ADR/EM
Operation voltage	15-30V DC
Maximum power consumption	1.6W
Light source intensity	150lm
Degrees of cover protection	IP40
Produced in accordance with	EN 60598-1, EN 60598-2-22, EN 55015, EN 61547, EN 1838
Operation temperature range	-30 to 50 °C
Relative humidity	up to 95%
Construction materials	Aluminum, plexiglas, Bayblend FR3010
External dimensions	290x172x38mm
Typical weight	650 gr.
Guarantee	3 years

Thank you for your trust in our products
Olympia Electronics - European manufacturer

GENERAL

1. Operations for installation, maintenance or testing must be done by authorized personnel only.
2. The device, must be connected **only** to the GR-8600 panel via its ADR line.
3. First set the address before installation. To address the device see page 4.

ADDRESS OPERATION

For address operations refer to the installation manual of the panel. *Please see manual of CBS panel GR-8600 for maximum number of luminaires that can be interconnected.*

INSTALLATION INSTRUCTIONS

ELECTRICAL CONNECTIONS

- ① Dismantle the luminaire by pushing the lock/unlock button and slide the luminaire to the right and pull it down.
- ② Pass the cables through the entry hole and connect them as shown on the picture (*please respect the polarity*).
- ③ Place upwards the luminaire and slide it to the left. The lock/unlock button appears indicating that the luminaire is securely installed.
- ④ Power on the device (see GR-8600 manual).

FLAG MOUNTING INSTALLATION (optional)

Install the flag mounting base on the wall (page 2) and perform the respective steps of the electrical connections.

SURFACE MOUNTING ON A WALL (single sided)

Install the included bracket on the wall (page 2) and perform the respective steps of the electrical connections.

CEILING INSTALLATION

Install the mounting base on the ceiling (page 2) and perform the respective steps of the electrical connections.

HANGING INSTALLATION (optional)

Install the mounting base (tube) on the ceiling (page 3) and perform the respective steps of the electrical connections.

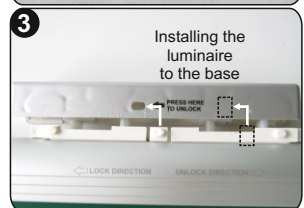
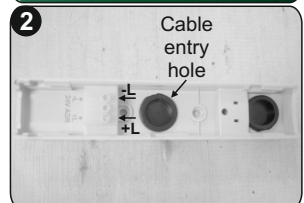

MOUNTING METHODS

A-1133 SET FLAG MOUNTED ON A WALL (OPTIONAL AFTER REQUEST)

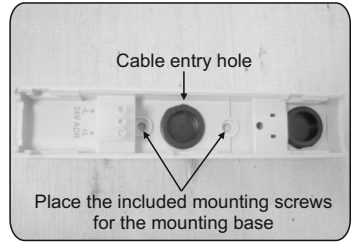
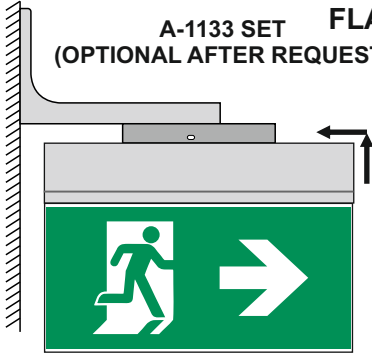

SURFACE MOUNTING ON A WALL (single side luminaire)

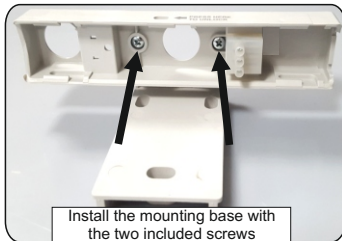
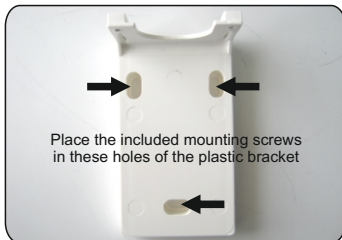

A-1134 SET (INCLUDED IN THE PACKAGE)

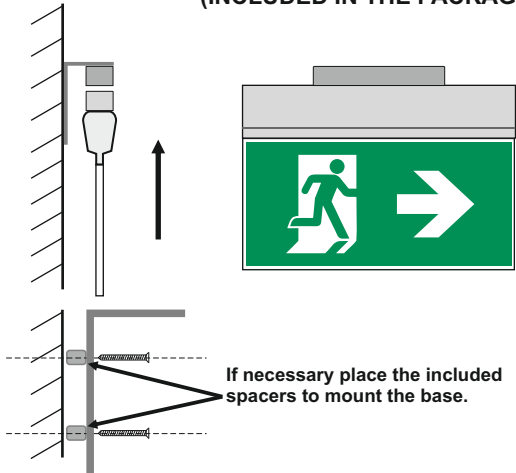

CEILING MOUNTED

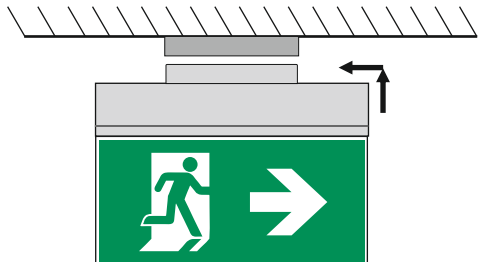
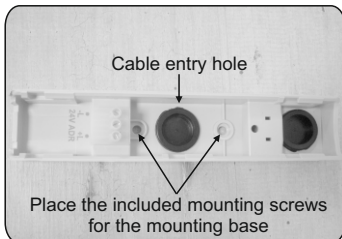

HANGING INSTALLATION

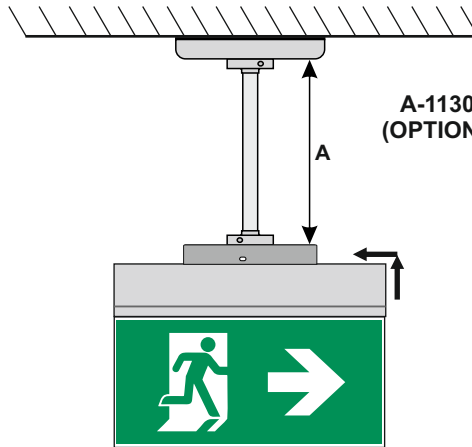

A-1130, A-1131, A-1132 SET
(OPTIONAL AFTER REQUEST)

	Tube
A-1130	A=1m
A-1131	A=0.5m
A-1132	A=0.25m

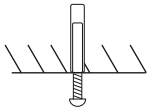

GENERAL!!

Measure the distance of the mounting holes and after the drilling place on these spots the mounting plugs and fasten the base with the mounting screws.

LED MODULE CHARACTERISTICS

ZLD-28/24V/ADR/EM	
Manufacturer	Olympia Electronics S.A
Model Number	1111153
Voltage Range	8.5-10.5V DC
Nominal Power	1200mW
Connections	Non reversible connection between main pcb and led module
Temperature (tc)	45 °C max. across the board



The light source contained in this luminaire shall only be replaced by the manufacturer, or his agent, or a similar qualified person.

NOTE! The light source is non-user replaceable.

NOTE: LED= Light Emitting Diode

LABELING EXPLANATION:

Z: Central supply

1: Maintained

C: Including inhibiting mode

G: Internally illuminated safety sign

Addressing process

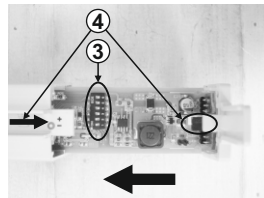
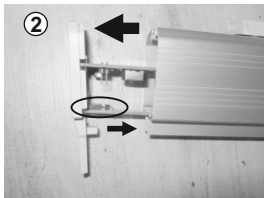
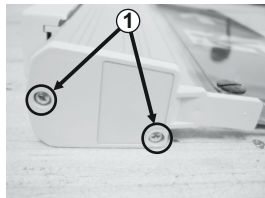

1. Unfasten the 2 screws.
2. Slide out carefully the electronic parts and remove the marking panel. Slide to the right the led strip to access the address switches.
3. Set the address according to the following options.
4. Slide carefully to the right the led strip to connect it to the respective connector. Slide in carefully all the electronic parts and refit the marking panel.
5. Fasten the removed screws in step 1.

WARNING!! Use a maximum torque of 0,25Nm to tighten the screws.

Address	Dipswitch setting	Address	Dipswitch setting	Address	Dipswitch setting	Address	Dipswitch setting
1		11		21		31	
2		12		22		32	
3		13		23			
4		14		24			
5		15		25			
6		16		26			
7		17		27			
8		18		28			
9		19		29			
10		20		30			

WARRANTY

Olympia Electronics guarantees the quality, condition and operation of the goods. The period of warranty is specified in the official catalogue of Olympia Electronics and also in the technical leaflet, which accompanies each product. This warranty ceases to exist if the buyer does not follow the technical instructions included in official documents given by Olympia Electronics or if the buyer modifies the goods provided or has any repairs or re-setting done by a third party, unless Olympia Electronics has fully agreed to them in writing. Products that have been damaged can be returned to the premises of our company for repair or replacement, as long as the warranty period is valid. Olympia Electronics reserves the right to repair or to replace the returned goods and to or not charge the buyer depending on the reason of deflection. Olympia Electronics reserves the right to charge or not the buyer the transportation cost.

HEAD OFFICE

72nd km. O.N.R. Thessaloniki-Katerini
P.C. 60300 P.O. Box 06 Eginio Pierias Greece

www.olympia-electronics.gr
info@olympia-electronics.gr