



GR-151-3/L "CLASSIC LIGHT" SERIES FOR NON MAINTAINED / MAINTAINED (OPTIONAL) LUMINAIRES



TECHNICAL CHARACTERISTICS (for LED MODULE Specs. see page 2)

| | |
|--------------------------------|---|
| OPERATION VOLTAGE | 220-240V AC/50-60Hz |
| MAXIMUM POWER CONSUMPTION | 3W / 4VA |
| BATTERY (Ni-Cd) | 3.6V/1Ah |
| BATTERY PROTECTION | From overcharge and deep discharge |
| INDICATIONS - CONTROLS | Battery charging LED, TEST button |
| CHARGING TIME | 24h |
| MINIMUM AUTONOMOUS DURATION | 180 min |
| ILLUMINATION SOURCE | White LEDs |
| ILLUMINATION (mains/emergency) | 30lm/75lm |
| DEGREES OF COVER PROTECTION | IP20 |
| PRODUCED IN ACCORDANCE WITH | EN 60598-1, EN 60598-2-22, EN 55015, EN 61547, EN 61000-3-2, EN 61000-3-3 |
| OPERATION TEMPERATURE RANGE | 5 to 40 °C |
| RELATIVE HUMIDITY | Up to 95% |
| CONSTRUCTION MATERIALS | Bayblend FR3010, transparent polycarbonate |
| EXTERNAL DIMENSIONS | 262 x 100 x 70 mm |
| TYPICAL WEIGHT | 590gr. |
| GUARANTEE | 3 years (1 year for the battery) |

**Thank you for your trust in our products
Olympia Electronics - European manufacturer**

GENERAL

These luminaires are used indoors (ta 40°C) where emergency light is needed. Each luminaire must be permanently connected to mains power supply. In normal operation the led strip lights and the battery is charging. In case of a mains power supply failure the luminaire will light the led strip automatically in emergency mode. When the mains power supply is restored the device turns to normal operation.

NON MAINTAINED OPERATION

By default the luminaire operates as maintained. The luminaire has a possibility to operate as non maintained. To change the maintained to non maintained operation follow the relative instructions on page 2.

LED STRIP CHECK (with normal power supply in maintained operation or in emergency operation with the led strip powered). By pressing continuously the **(led strip check)** button, an intentional disconnection of the led strip is carried out and that is indicated by the red indication led. When the button is released the indication led will be turned off. So in every disconnection of the led strip, the red led will indicate it.

INSTALLATION

To install the luminaire follow the installation instructions on page 2.

ATTENTION!!!

1. Operations for installation, maintenance or testing must be done by authorized personnel only.
2. The device must be connected to the mains power supply through a fuse dependent by the total amount of the line's power load.
3. It is suggested to check every month the indication LED for battery charging, and by pushing the TEST button to check the emergency circuit. The led strip should: a) light with bigger intensity as long as the TEST button is pressed (maintained operation), b) light as long as the TEST button is pressed (non-maintained operation). If the luminaire doesn't work as described above contact the installer.
4. It is suggested to check every 6 months the minimum autonomous duration by disconnecting the mains power supply. Count the time that the led strip lights and in case of less time than the minimum autonomous duration the battery must be replaced. If the measured time is considerably less than the minimum autonomous duration **contact the installer**. In case of battery or led strip replacement, these must be replaced by parts of the same type.

5. In case of inactive use for a period greater than 2 months, disconnect the battery by pulling out the battery's connector.

6. **It is not allowed to discard batteries in to common trash bins, they must be discarded only in battery recycling points. Do not incinerate.**



INSTALLATION INSTRUCTIONS

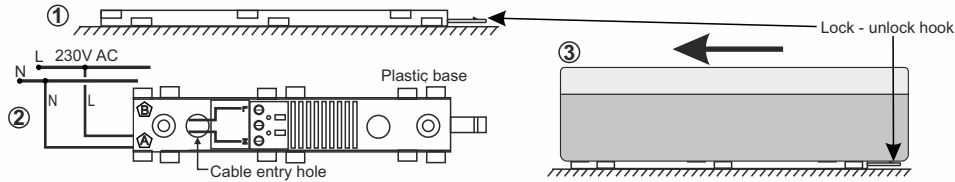

- ① Detach the plastic base (located in the bottom of the luminaire) by pulling the unlock hook and pass the cables from area Ⓐ or Ⓑ and through the cable entry hole. The luminaire must be connected to a permanent electrical installation to ensure the immobilization of the cable. Mount the plastic base with the included mounting accessories.
- ② Connect the mains cables to the respective detachable terminal block. **N for neutral, L for live wire.**
- ③ Attach the luminaire by sliding it on the plastic base until the plastic hook locks, and power the Luminaire.

MAINTAINED TO NON MAINTAINED SELECTION CAPABILITY

- ④ Power on the luminaire and press continuously the TEST button for 10 seconds, until the battery charging LED blinks and the led strip turns off. The luminaire operates now as non maintained luminaire. If you want to restore the previous condition (maintained operation), press continuously the TEST button for 10 seconds, until the battery charging LED blinks and the led strip lights with less luminosity.

NOTE!! After finishing the installation you must power the device at least for 24 hours for battery charging to perform the nominal autonomy.

LED MODULE CHARACTERISTICS

| LED MODULE CHARACTERISTICS | |
|----------------------------|--|
| GR-151-3/L | |
| Manufacturer | Olympia Electronics S.A. |
| Model Number | 2801101 |
| Voltage Range | 8.7-10.8VDC |
| Nominal Power | 0.59W |
| Connections | Cable connection between main pcb and led module |
| Temperature (tc) | 45 °C max. across the board |

Battery replacement

It can be done only by a competent person and after the mains interruption

1. Detach the luminaire from its base (step 1 of the installation procedure).
2. Use a flat blade screwdriver to remove the diffuser.
3. Remove the reflector.
4. Disconnect the connector and remove the old battery.
5. Connect the new battery with the same type and place it in the position of the old one.
6. Replace the removed parts (step 1, 2 and 3).

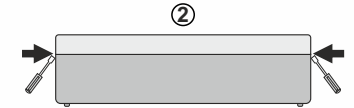

NOTE: LED= Light Emitting Diode
LABELING EXPLANATION:
X: Self contained
1: Maintained (*)
A: Including test device
G: Internally illuminated safety sign
***180:** 3 hours duration

Note!! The installer should fill in, on the specification label, the letter **G** if the luminaire is used as a safety sign.

X 1 A G 1 8 0

(* Maintained operation: The luminaire lights its illumination source, when it is powered by the mains power supply or not.

Non Maintained operation: The luminaire lights its illumination source, only in power supply's failure.



The light source contained in this luminaire shall only be replaced by the manufacturer, or his agent, or a similar qualified person.

NOTE! The light source is non-user replaceable.

WARRANTY

Olympia Electronics guarantees the quality, condition and operation of the goods. The period of warranty is specified in the official catalogue of Olympia Electronics and also in the technical leaflet, which accompanies each product. This warranty ceases to exist if the buyer does not follow the technical instructions included in official documents given by Olympia Electronics or if the buyer modifies the goods provided or has any repairs or re-setting done by a third party, unless Olympia Electronics has fully agreed to them in writing. Products that have been damaged can be returned to the premises of our company for repair or replacement, as long as the warranty period is valid. Olympia Electronics reserves the right to repair or to replace the returned goods and to or not charge the buyer depending on the reason of deflection. Olympia Electronics reserves the right to charge or not the buyer the transportation cost.

HEAD OFFICE

72nd km. O.N.R. Thessaloniki-Katerini
P.C. 60300 P.O. Box 06 Eginio Pierias Greece

www.olympia-electronics.gr
info@olympia-electronics.gr