

Package Contents

- 1 Luminaire
- 1 Set of Pictograms
- 1 Mounting accessories
- 1 Manual

General

These devices are used indoors and outdoors (ta 40°C) in places where emergency light is needed. Each device must be permanently connected to mains power supply. In normal operation the battery is charging. The light source can be either on or off, depending on user's choice. In case of a mains power supply failure, the device enters emergency mode and the illumination LED turns on. When the mains power supply is restored the device turns to normal operation.

Manual Operational Test

Manual Operational Test can be initiated by placing the magnetic test card (A-1900) on the side of the indications and removing it instantly. The light source and the emergency circuit of the device are tested. The manual test can be conducted only if the mains power supply and the battery are connected. During this test period the LAMP TEST LED will blink. The battery must have adequate charge. This test lasts for 3 seconds.

Manual Autonomy Test

Manual Autonomy Test can be initiated by placing the magnetic test card (A-1900) on the side of the indications and keep it steadily for 5 to 10 seconds. In order to be performed, the mains power supply should be connected and the battery should be fully charged. The luminaire enters emergency mode, the CHARGE LED is turned OFF and the BATTERY FAULT LED starts blinking. Its duration is the stated autonomy duration of the luminaire. If at the end of the test the autonomy is lower than the nominal, the BATTERY FAULT LED will lit and battery needs to be replaced. If the result of the test is good then the luminaire enters charging mode and the CHARGE LED starts blinking until the battery is fully charged.

Automatic Operational Test

This test includes all the operations that are provided in Manual Operational Test and is conducted automatically every 15 days and lasts 3 seconds.

Indications LED Status

CHARGE (green)	LAMP FAULT (red)	BATT. FAULT (yellow)	Description
			Charging
			Fully charged
			Battery fault or emergency mode
			Operational test
			Light source fault
			Autonomy test
			Duration fault

Note:

	Permanently ON
	Blink
	Off
	Indifferent

Installation Instructions

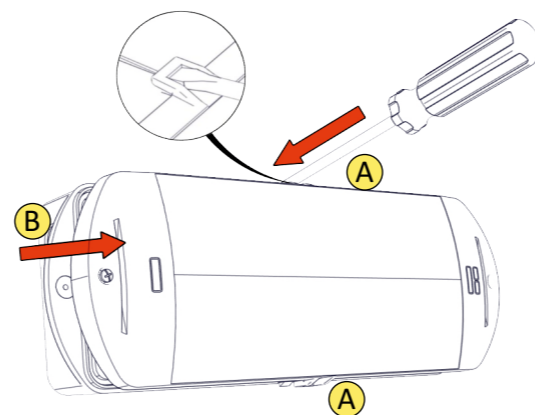

Place a flat blade screwdriver to unclip the two plastic latches (A) and pull up gently the diffuser (B) to remove it.

1

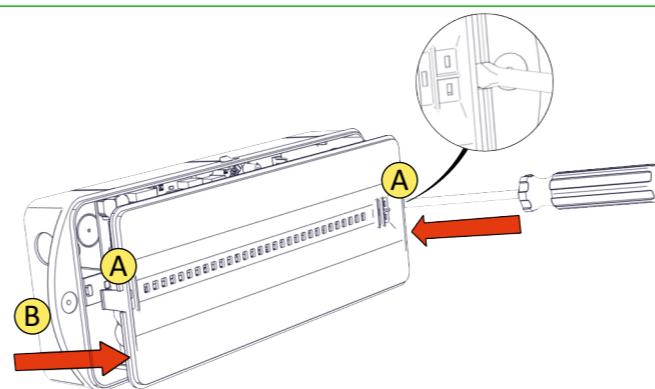

Place a flat blade screwdriver to the recesses (A) and pull up gently the reflector (B) to remove it.

2

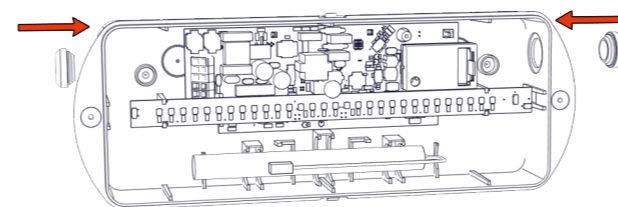

Install the two rubber gaskets to the holes of the base. Make sure that they are not deformed.

3

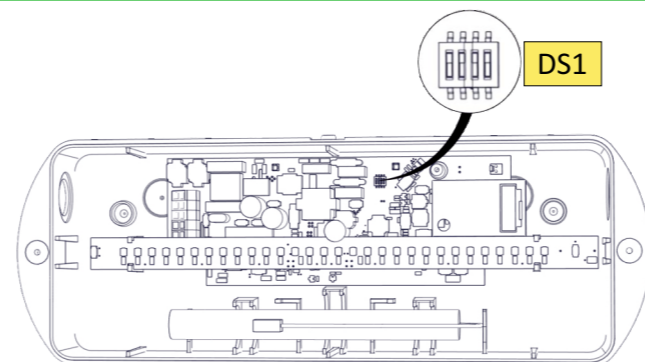

Autonomy Duration Selection

The user can select one of the 3 available minimum autonomy durations 1 hour, 3 hours and 8 hours. The selection must be done while the luminaire is disconnected from AC and battery supplies. The selection is achieved through Switches 2 & 3 of DS1 as shown below.

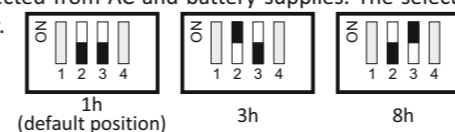

Technical Label Installation

Two additional labels are included in the package. one for 3 hours duration (180) and one for 8 hour duration (480). Depending on the selected duration, the installer must cover the default 1 hour (60) printing with one label that has the required duration. Please take notice of the orientation of the label.

4

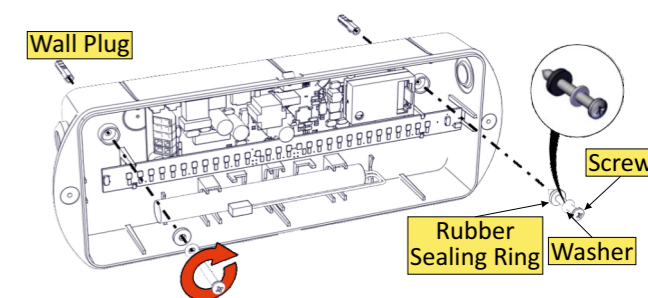

Install the plastic base (with the included mounting accessories).

WARNING!! To preserve the IP65 rating, fit the screws with the metallic washers and rubber sealing rings.

5

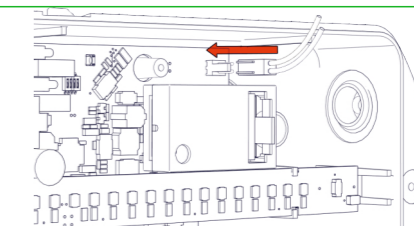

Place the battery's connector to the corresponding connector on the PCB.

6

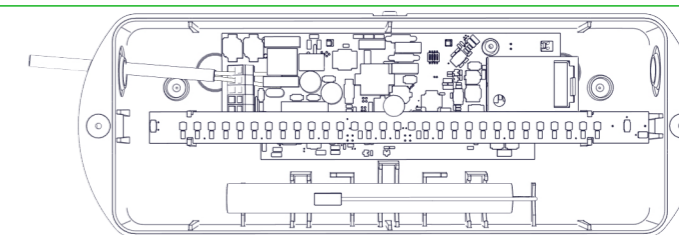

Make a hole in the center of the rubber gasket by using a small screwdriver. Pass the round cable through the rubber gasket. Connect the mains cable according to the connections diagrams below.

7 a) Permanent Maintained Operation

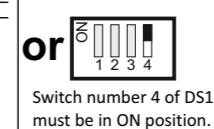
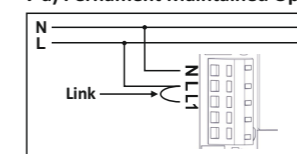

7 b) Non-Maintained Operation

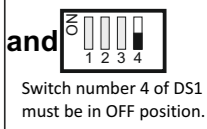
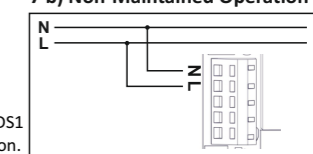

7 c) Controlled Maintained Operation of the lamp

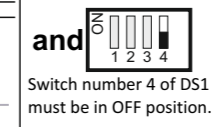
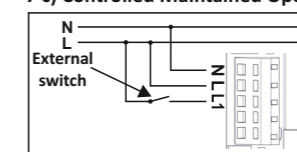

Install the included tie-wrap to the adhesive tether loop and fasten securely the power cable in order to anchor it.

N for neutral, L for live wire **WARNING!!** Isolate the mains power supply before making the connections.

7

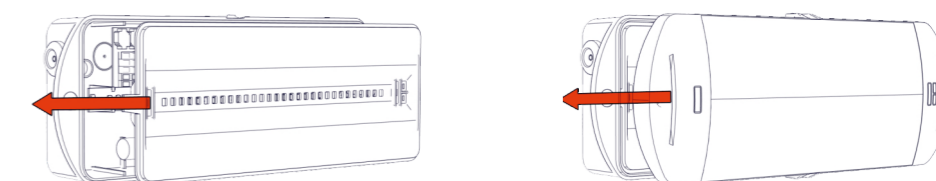

Refit the reflector and then the diffuser, which were removed in steps 1 & 2. Mind the holes of the indications.

8

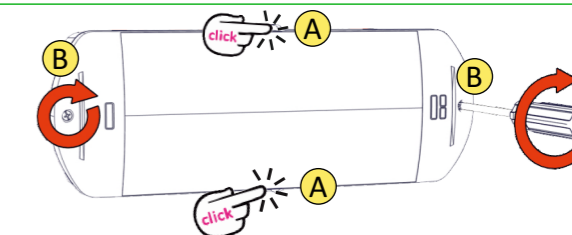

The plastic latches (A) must be secured (click sound). Fasten the 2 screws (B). (Tightening torque 1.2N*m)

9

NOTE!!

After finishing the installation you must power the luminaire for at least 24 hours in order to completely charge the battery. The rated autonomy duration can be achieved after that time.

3

923195100_09_001

Battery Replacement

It can be done only by a competent person and after the mains interruption.

1. Follow step 1 of the installation instructions and remove the diffusor.
2. Follow step 2 of the installation instructions and remove the reflector.
3. Remove the old battery and place a new one of the same type and characteristics.
4. Replace the removed parts (previous steps 1 and 2).

Magnetic Test Card

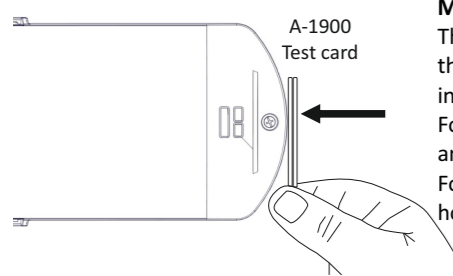

Manual TESTS with the A-1900 Test card (not included).

This card is available only after request. In order to test the device you must place the card on the side of the indications.

For Manual Operational Test, you must place the card and remove it immediately.

For Manual Autonomy Test, you must place the card and hold it for 5 to 10 seconds.

Dimensional Drawings

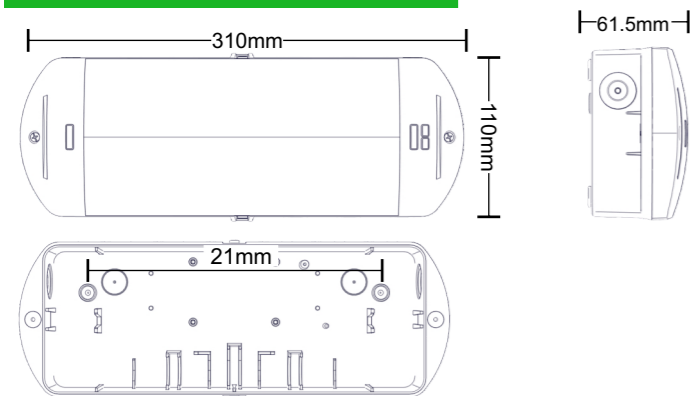

NOTE: LED= Light Emitting Diode

LABELING EXPLANATION:

X: Self contained

1: Maintained operation (*)

A: Including test device

B: Including remote test mode

C: Including inhibiting mode

F: Automatic test gear complying with IEC 61347-2-7 denoted EL-T

G: Internally illuminated safety sign

60: 1 hour duration

180: 3 hours duration

480: 8 hours duration

(*) Maintained operation: The luminaire lights its illumination source, when it is powered by the mains power supply or not.

Non Maintained operation: The luminaire lights its illumination source, only in mains power supply's failure.

NOTE!! The installer should fill in, on the specification label, the letter **G** if the luminaire is used as a safety sign.

X 1 A B C F 60
↑
G

ATTENTION!!!

 The light source contained in this luminaire shall only be replaced by the manufacturer, or his agent, or a similar qualified person.

NOTE!! The light source is non-user replaceable.



CAUTION : Do not view directly with bare eyes.

Technical Characteristics

GR-1951/HL/WL	
OPERATION VOLTAGE	220-240V AC / 50-60Hz
MAXIMUM POWER CONSUMPTION	5.2W / 5.5VA
SUPPLY CURRENT	25mA
U-OUT	18V
Prated	1h: 1.9W 3h: 1.7W 8h: 0.5W
Irated	1h: 175mA 3h: 150mA 8h: 50mA
MAX OPEN CIRCUIT VOLTAGE	39V
WIRE CROSS SECTION	0.08mm ² - 4mm ²
MINIMUM POWER FACTOR	0.94
BATTERY (Ni-Cd)	3.6V/3 Ah
Tx/Rx FREQUENCY RANGE	868-870MHz
Tx POWER	11dBm
INSULATION BETWEEN SUPPLY & CONTROL TERMINALS	Basic insulation
BATTERY PROTECTION	Deep discharge and overcharge protection / the control gear will recharge the battery normally after the test of 22.3
MIN MAX. DISCHARGE VOLTAGE	3-4.5V
MIN MAX. DISCHARGE CURRENT	200-870mA
MIN MAX. CHARGE CURRENT	192-200mA
TRICKLE CHARGE VOLTAGE/CURRENT	4.7V / 90mA
MAX CHARGE VOLTAGE	4.8V
INDICATIONS	LED Charge, Lamp Fault LED, Battery Fault LED
CHARGE TIME	23 hours
MINIMUM DURATION	1 h, 3 h, 8 h
LIGHT SOURCE	28 white LEDs
LIGHT SOURCE LUMINOUS FLUX (MAINS / EMERGENCY)	340lm / 350lm (1 h), 320lm (3 h), 100lm (8 h)
DEGREES OF COVER PROTECTION	IP65
PRODUCED IN ACCORDANCE WITH	EN 60598-1, EN 60598-2-22, EN 55015, EN 61547, EN 61000-3-2, EN 61000-3-3, ETSI EN 303 446-1 v1.1.0, ETSI EN 300 220-2 v3.1.1
VIEWING DISTANCE (as safety sign)	22m
CONTROL GEAR MAX. TEMPERATURE:tc	60 °C at D11
OPERATION TEMPERATURE RANGE	5 to 40 °C
RELATIVE HUMIDITY	Up to 95%
CONSTRUCTION MATERIAL	ABS/PC, PC
EXTERNAL DIMENSION (L x W x H)	310 x 110 x 61.5 mm
WEIGHT	750gr.
GUARANTEE	3 years (1 year for the battery)
CONTROL GEAR WITH AUTOMATIC TEST FUNCTION	EL-T

LED Characteristics

GR-1951/HL/WL	
MANUFACTURER	Olympia Electronics S.A.
MODEL NUMBER	2106195
VOLTAGE RANGE	8.4 - 12.4V
NOMINAL POWER	1h: 1.8W 3h: 1.7W 8h: 0.5W
CONNECTIONS	PIN Connection between main PCB and LED module
TEMPERATURE (tc)	42 °C max. across the board

Warranty

Olympia Electronics guarantees the quality, condition and operation of the goods. The period of warranty is specified in the official catalogue of Olympia Electronics and also in the technical leaflet, which accompanies each product. This warranty ceases to exist if the buyer does not follow the technical instructions included in official documents given by Olympia Electronics or if the buyer modifies the goods provided or has any repairs or re-setting done by a third party, unless Olympia Electronics has fully agreed to them in writing. Products that have been damaged can be returned to the premises of our company for repair or replacement, as long as the warranty period is valid.

Olympia Electronics reserves the right to repair or to replace the returned goods and to or not charge the buyer depending on the reason of defection. Olympia Electronics reserves the right to charge or not the buyer the transportation cost.



72nd km. O.N.R. Thessaloniki-Katerini
P.C. 60300 P.O. Box 06 Eginio Pierias Greece

www.olympia-electronics.com

info@olympia-electronics.gr



GR-1951/HL/WL

**WATERPROOF SELF TESTING EMERGENCY
MAINTAINED/NON MAINTAINED
LUMINAIRE HIGH LUMINATION
WITH WIRELESS COMMUNICATION**



Thank you for your trust in our products
Olympia Electronics - European manufacturer