



NON MAINTAINED SPOT LIGHT EMERGENCY LUMINAIRES WITH 1 WHITE POWER LED



TECHNICAL CHARACTERISTICS (for LED MODULE specifications see page 4)				
	GR-270	GR-271	GR-272	GR-273
OPERATION VOLTAGE	220-240V AC / 50-60Hz			
MAXIMUM POWER CONSUMPTION	2.4W / 2.7VA			
BATTERY (NI-MH)	3.6V/1.5Ah			
BATTERY PROTECTION	Deep discharge and overcharge protection			
INDICATIONS - CONTROLS	Charge, TEST button			
CHARGE TIME	24 hours			
MINIMUM DURATION	1.5 hour			3 hours
LIGHT SOURCE	1 white power LED			
EMERGENCY ILLUMINATION	160lm			120lm
DEGREES OF COVER PROTECTION	IP40			
PRODUCED IN ACCORDANCE WITH	EN 60598-1, EN 60598-2-22, EN 55015, EN 61547, EN 61000-3-2, EN 61000-3-3			
OPERATION TEMPERATURE RANGE	5 to 40 °C			
RELATIVE HUMIDITY	Up to 95%			
CONSTRUCTION MATERIAL	ABS/PC, PC			
EXTERNAL DIMENSION	Ø125 x 65 mm			
WEIGHT	345gr.			
GUARANTEE	3 years (1 year for the battery)			

**Thank you for your trust in our products
Olympia Electronics - European manufacturer**

GENERAL

These devices are used indoors (ta 40°C) in places where emergency luminaires are needed. The luminaires GR-270 and GR-272 are suitable for corridors lighting and the GR-271 and GR-273 for open area lighting. Each device must be permanently connected to mains power supply. In normal operation the battery is charging. In case of a mains power supply failure the device will light the illumination led automatically in emergency mode. When the mains power supply is restored the device turns to normal operation.

INSTALLATION

To install the luminaire follow the installation instructions on page 2.

ATTENTION!!!

- Operations for installation, maintainance or testing must be done by authorized personnel only.
- The device must be connected to the mains power supply thru a fuse dependent by the total amount of the line's power load.
- It is suggested to check every month the indication LED for battery charging, and by pushing the TEST button (use a pointy tool

with diameter of 2mm max.) to check the emergency circuit. The illumination LED should light as long as the TEST button is pressed. In the opposite condition contact the installer.

- It is suggested to check every 6 months the minimum autonomous duration by disconnecting the mains power supply. Count the time that the luminaire lights and in case of less time than the minimum autonomous duration the battery must be replaced. If the measured time is considerably less than the minimum autonomous duration contact the installer. In case of battery or light source replacement, these must be replaced by parts of the same type, by the manufacturer or by a competent person.
- In case of inactive use for a period greater than 2 months, disconnect the battery by pulling out the battery's connector.
- It is not allowed to discard batteries in to common trash bins, they must be discarded only in battery recycling points. Do not incinerate.**





The light source contained in this luminaire shall only be replaced by the manufacturer, or his agent, or a similar qualified person.

NOTE! The light source is non-user replaceable.

INSTALLATION INSTRUCTIONS

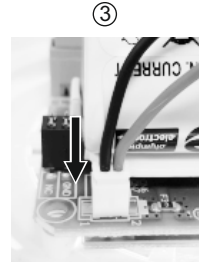
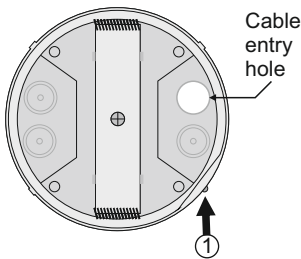

Initial installation

- ① Untighten the screw and pull up the reflector.
- ② **Always use in any case round mains cable, with a diameter of 5-10mm (H05RN-F type 2x1mm² or any other type, at least equal to it's mechanical and electrical properties). ATTENTION!! The cable must not be deformed in any way (This requirement is important to ensure the IP rating).** Install the included gaskets in to the cable entry holes (verify that are not deformed). Make a hole in the center by using a small screwdriver. Pass the round cable through the gasket. Detach the power terminal, connect the wires as shown in the picture and attach the power terminal (10A max).
- ③ Place the battery's connector to the corresponding connector on the P.C.B.
- ④ Refit the reflector (mind the correct orientation), tighten the screw securely and the luminaire is ready for mounting.

NOTE!! After finishing the installation you must power the luminaire for, at least, 24 hours for battery charging to perform the nominal autonomy.

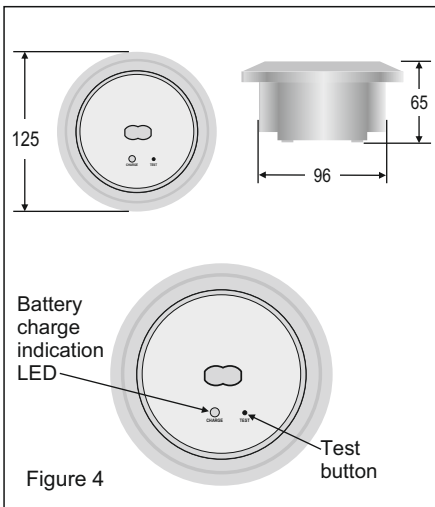

GR-270, GR-272

Corridor lighting

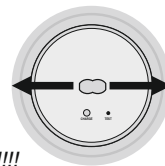

ATTENTION!!!
During installation follow this light direction.

GR-271, GR-273

Open area lighting

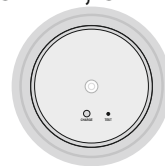

Mounting the lamp in suspended ceiling.

Set up the lamp to the suspended ceiling as it is shown bellow (*Required opening 110mm*):

Step 1

Bend the springs, to get into the hole of the suspended ceiling, as you can see to the next figure.

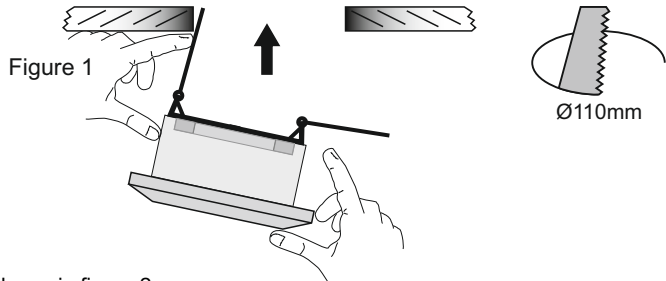

Step 2

Push up the luminaire, as shown in figure 2.

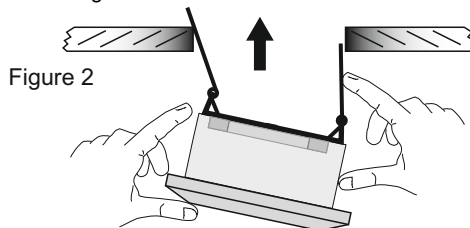

Step 3

Continue to push upwards until the lamp locks.

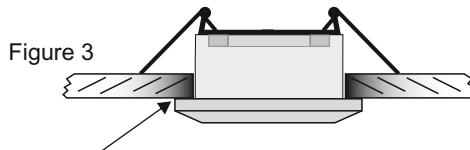

If you want to pull off the device, put a flat blade screwdriver, between the device and the ceiling.

Surface mounting

Install the luminaire according to the following steps:

Step 1. Follow the step 1 of the installation instructions.

Step 2. Unfasten the retaining screw (Figure 4) and detach the part for suspended ceiling installation.

Step 3. Drill 2 holes on the base (Figure 5) using a 4mm drill bit in order to permit the retaining screws to pass. Mark these two drilled points on the required mounting location, drill the holes and install the supplied plastic plugs. **ATTENTION!!** Especially for the GR-270 and GR-272 luminaire installation on the ceiling you must align the base with the indications on the luminaire's base.

Step 4. Install the decorative rim (package included). Next, use the 2 fasteners to install the unit to the require location.

Step 5. Follow the steps 2,3 and 4 of the installation instructions.

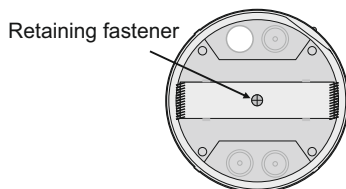

Figure 4

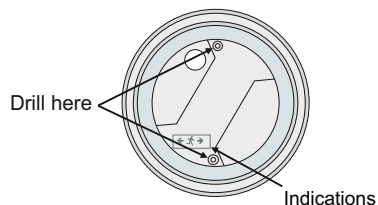

Figure 5

Battery replacement.***It can be done only by a competent person and after the mains interruption.***

1. Remove the luminaire from the suspended ceiling (figure 3).
2. Follow the step 1 of the installation instructions.
3. Disconnect the connector and remove the old battery.
4. Connect the new battery with the same type (step 2 of the installation instructions) and place it in the position of the old one.
5. Replace the removed parts (step 1 and 4) and power the device.

CAUTION : Do not view directly with bare eyes.
LED MODULE CHARACTERISTICS

	GR-270	GR-271	GR-272	GR-273
Manufacturer	Olympia Electronics S.A			
Model Number	1903175			
Voltage Range	5.8-6.2V DC			
Nominal Power	1.3W		1W	
Connections	Non reversible connection between main pcb and led module			
Temperature (tc)	60 °C max. across the board		45 °C max. across the board	

NOTE: LED= Light Emitting Diode

LABELING EXPLANATION:
X: Self contained

0: Non maintained (*)

A: Including test device

90: 1.5 hour duration

180: 3 hours duration

(*) Non Maintained operation: The luminaire lights its illumination source, only in power supply's failure.

Maintained operation: The luminaire lights its illumination source, when it is powered by the mains power supply or not.

WARRANTY

Olympia Electronics guarantees the quality, condition and operation of the goods. The period of warranty is specified in the official catalogue of Olympia Electronics and also in the technical leaflet, which accompanies each product. This warranty ceases to exist if the buyer does not follow the technical instructions included in official documents given by Olympia Electronics or if the buyer modifies the goods provided or has any repairs or re-setting done by a third party, unless Olympia Electronics has fully agreed to them in writing. Products that have been damaged can be returned to the premises of our company for repair or replacement, as long as the warranty period is valid.

Olympia Electronics reserves the right to repair or to replace the returned goods and to or not charge the buyer depending on the reason of defection. Olympia Electronics reserves the right to charge or not the buyer the transportation cost.

HEAD OFFICE

72nd km. O.N.R. Thessaloniki-Katerini
P.C. 60300 P.O. Box 06 Eginio Pierias Greece

www.olympia-electronics.gr

info@olympia-electronics.gr