

ADDRESSABLE EMERGENCY LUMINAIRES FOR GR-8600 CBS WITH 1 WHITE POWER LED



TECHNICAL CHARACTERISTICS *(for LED MODULE specifications see page 3)*

	GR-280/24V/ADR	GR-281/24V/ADR
OPERATION VOLTAGE	15-30V DC	
MAXIMUM POWER CONSUMPTION	3.2W	
ILLUMINATION SOURCE	1 white power LED	
ILLUMINATION	270lm	
DEGREES OF COVER PROTECTION	IP40	
PRODUCED IN ACCORDANCE WITH	EN 60598-1, EN 60598-2-22, EN 55015, EN 61547	
OPERATION TEMPERATURE RANGE	-30 to 50 °C	
RELATIVE HUMIDITY	up to 95%	
CONSTRUCTION MATERIALS	ABS/PC, PC	
EXTERNAL DIMENSIONS	Ø125 x 65 mm	
TYPICAL WEIGHT	214gr.	
GUARANTEE	3 years	

Thank you for your trust in our products
Olympia Electronics - European manufacturer

GENERAL

The GR-280/24V/ADR luminaires are suitable for corridors lighting and the GR-281/24V/ADR for open area lighting.

1. Operations for installation, maintenance or testing must be done by authorized personnel only.
2. The device, must be connected **only** to the GR-8600 panel via its ADR line.
3. First set the address before installation.

To address the device see page 3.

ADDRESS OPERATION

For address operations refer to the

installation manual of the panel. *Please see manual of CBS panel GR-8600 for maximum number of luminaires that can be interconnected.*

INSTALLATION

To install the luminaire follow the installation procedure as described below.

NOTE: LED= Light Emitting Diode

LABELING EXPLANATION:

Z: Central supply

1: Maintained

C: Including inhibiting mode

INSTALLATION INSTRUCTIONS

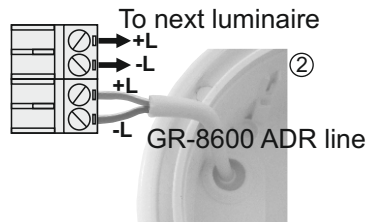
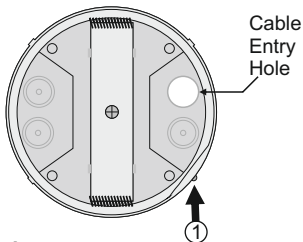

Initial installation

- 1 Untighten the screw but do not remove it and pull up the reflector.
- 2 **Always use in any case round mains cable, with a suitable diameter to fit tightly into the gasket. ATTENTION!! The cable must not be deformed in any way (This requirement is important to ensure the IP rating).** Always refer to GR-8600 manual regarding to the cable's cross section's selection. Install the included gaskets into the cable entry holes (*verify that are not deformed*). Make a hole in the center by using a small screwdriver. Pass the round cable through the gasket. Detach the power terminal, connect the wires as shown in the picture and attach the power terminal.
- 3 Refit the reflector (mind the correct orientation), tighten the screw securely and the luminaire is ready for mounting.

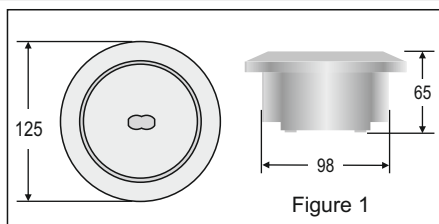
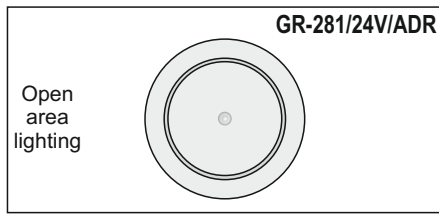
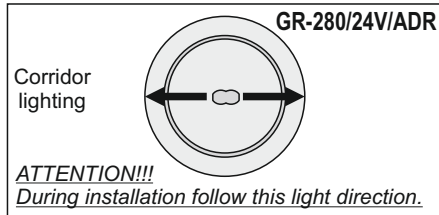

Figure 1



Mounting the lamp in suspended ceiling.

Set up the lamp to the suspended ceiling as it is shown below (*Required opening 110mm*):

Step 1

Bend the springs, to get into the hole of the suspended ceiling, as you can see to the next figure.

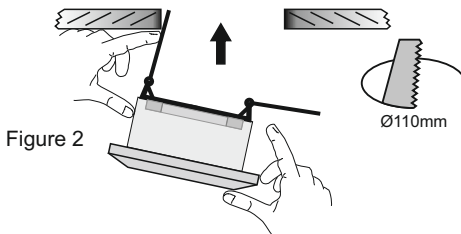

Figure 2

Step 2

Push up the luminaire, as shown in figure 3.

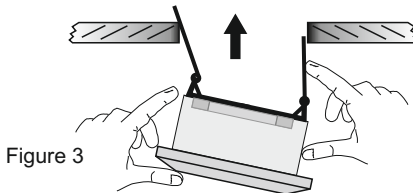

Figure 3

Step 3

Continue to push upwards and the lamp locks.

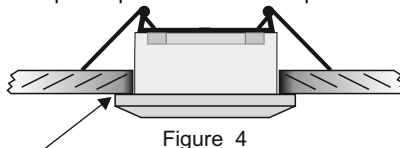

Figure 4

If you want to pull off the device, put a flat blade screwdriver, between the device and the ceiling.



CAUTION : Do not view directly with bare eyes.

Surface mounting

Install the luminaire according to following steps:

Step 1. Follow the step 1 of the installation instructions.

Step 2. Unfasten the retaining screw (Figure 5) and detach the part for suspended ceiling installation.

Step 3. Drill 2 holes on the base (Figure 6) using a 4mm drill bit in order to permit the retaining screws to pass. Mark these two drilled points on the required mounting location, drill the holes and install the supplied plastic plugs. **ATTENTION!!! Especially for the GR-280/24V/ADR luminaire installation on the ceiling you must align the base with the indications on the luminaire's base.**

Step 4. Install the decorative rim (package included). Next, use the 2 fasteners to install the unit to the require location.

Step 5. Follow the step 3 of the installation instructions.

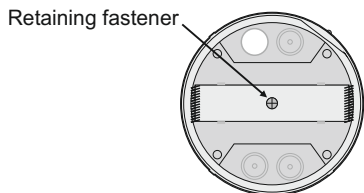

Figure 5

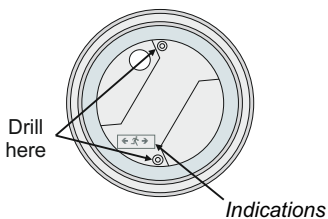

Figure 6

Addressing process

1. Follow the step 1 of the installation instructions to access the address switches.
2. Set the address according to the following options.
3. Refit the removed parts in step 1.

Address	Dipswitch setting	Address	Dipswitch setting	Address	Dipswitch setting	Address	Dipswitch setting
1		11		21		31	
2		12		22		32	
3		13		23			
4		14		24			
5		15		25			
6		16		26			
7		17		27			
8		18		28			
9		19		29			
10		20		30			



The light source contained in this luminaire shall only be replaced by the manufacturer, or his agent, or a similar qualified person.

NOTE! *The light source is non-user replaceable.*

LED MODULE CHARACTERISTICS

	GR-280/24V/ADR	GR-281/24V/ADR
Manufacturer	Olympia Electronics S.A.	
Model Number	1110143	
Voltage Range	2.75 -3.4V DC	
Nominal Power	2.4W	
Connections	Non reversible connection between main pcb and led module	
Temperature (tc)	70 °C max. across the board	

WARRANTY

Olympia Electronics guarantees the quality, condition and operation of the goods. The period of warranty is specified in the official catalogue of Olympia Electronics and also in the technical leaflet, which accompanies each product. This warranty ceases to exist if the buyer does not follow the technical instructions included in official documents given by Olympia Electronics or if the buyer modifies the goods provided or has any repairs or re-setting done by a third party, unless Olympia Electronics has fully agreed to them in writing. Products that have been damaged can be returned to the premises of our company for repair or replacement, as long as the warranty period is valid.

Olympia Electronics reserves the right to repair or to replace the returned goods and to or not charge the buyer depending on the reason of deflection. Olympia Electronics reserves the right to charge or not the buyer the transportation cost.

HEAD OFFICE

72nd km. O.N.R. Thessaloniki-Katerini
P.C. 60300 P.O. Box 06 Eginio Pierias Greece
www.olympia-electronics.gr
info@olympia-electronics.gr