

Surface Mounting

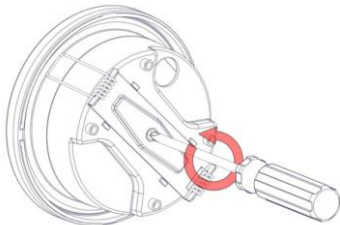

Unfasten the retaining screw and detach the part for suspended ceiling installation.

1

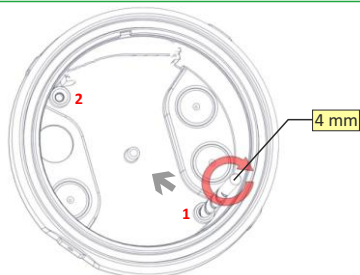

Drill 2 holes on the base using a 4mm drill bit in order to permit the retaining screws to pass. Mark these two drilled points on the required mounting location, drill the holes and install the supplied plastic plugs.

2

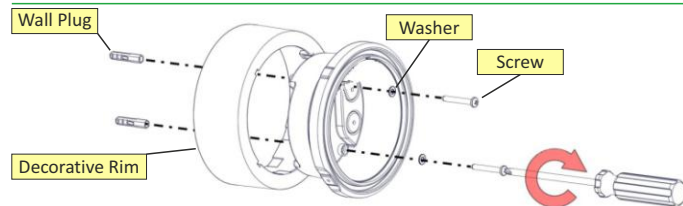

Install the decorative rim. Next, install the luminaire with the supplied mounting accessories to the required location.

3

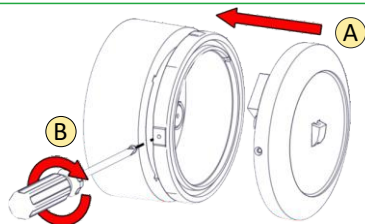

Refit the reflector (mind the correct orientation). Tighten the screw securely.

4

NOTE!!
According the mounting method and before mount the luminaire follow the installation instruction on page 2.

Technical Characteristics

GR-288

OPERATION VOLTAGE	90-250V DC, 120-250V AC / 50-60Hz
MAXIMUM POWER CONSUMPTION	2.6 W / 3 VA
LIGHT SOURCE	1 Power LED
ILLUMINATION	270lm
DEGREES OF COVER PROTECTION	IP40
PRODUCED IN ACCORDANCE WITH	EN 60598-1, EN 60598-2-22, EN 55015, EN 61547, EN 61000-3-2, EN 61000-3-3
OPERATION TEMPERATURE RANGE	-30 to 50 °C
RELATIVE HUMIDITY	Up to 95%
CONSTRUCTION MATERIAL	ABS/PC, PC
EXTERNAL DIMENSION	Ø 125 x 65 mm
WEIGHT	250gr.
GUARANTEE	3 years

LED Characteristics

GR-288

MANUFACTURER	Olympia Electronics S.A.
MODEL NUMBER	1110143
VOLTAGE RANGE	2.75 - 3.4V DC
NOMINAL POWER	2.4W
CONNECTIONS	Non reversible connection between main pcb and led module
TEMPERATURE (tc)	70 °C max. across the board

NOTE: LED= Light Emitting Diode

LABELING EXPLANATION:

Z: Central supply

1: Maintained operation (*) **Z 1**

(*) Maintained operation: The luminaire lights its illumination source, when it is powered by the mains power supply or not.

ATTENTION!!!



The light source contained in this luminaire shall only be replaced by the manufacturer, or his agent, or a similar qualified person.

NOTE! The light source is non-user replaceable.

Warranty

Olympia Electronics guarantees the quality, condition and operation of the goods. The period of warranty is specified in the official catalogue of Olympia Electronics and also in the technical leaflet, which accompanies each product. This warranty ceases to exist if the buyer does not follow the technical instructions included in official documents given by Olympia Electronics or if the buyer modifies the goods provided or has any repairs or re-setting done by a third party, unless Olympia Electronics has fully agreed to them in writing. Products that have been damaged can be returned to the premises of our company for repair or replacement, as long as the warranty period is valid.

Olympia Electronics reserves the right to repair or to replace the returned goods and to or not charge the buyer depending on the reason of deflection. Olympia Electronics reserves the right to charge or not the buyer the transportation cost.



72nd km. O.N.R. Thessaloniki-Katerini
P.C. 60300 P.O. Box 06 Eginio Pierias Greece
www.olympia-electronics.com
info@olympia-electronics.gr



GR-288

**MAINS EMERGENCY CEILING MOUNTED
LUMINAIRE CBS WITH 5LUX LENS**



Thank you for your trust in our products
Olympia Electronics - European manufacturer

Package Contents

- 1 Luminaire with decorative rim
- 1 Mounting accessories
- 1 Manual

General

These luminaires are used in places where emergency luminaires (CBS) are needed.

Each luminaire must be permanently connected to mains power supply.

INSTALLATION

To install the luminaire follow the installation procedure as described below.

ATTENTION!!!

Operations for installation, maintenance or testing must be done by authorized personnel, only when the device is disconnected from the mains power supply.

Dimensions

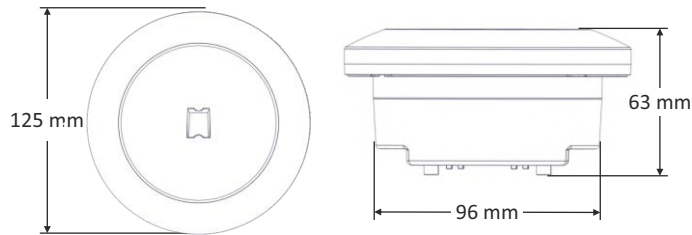

Lens

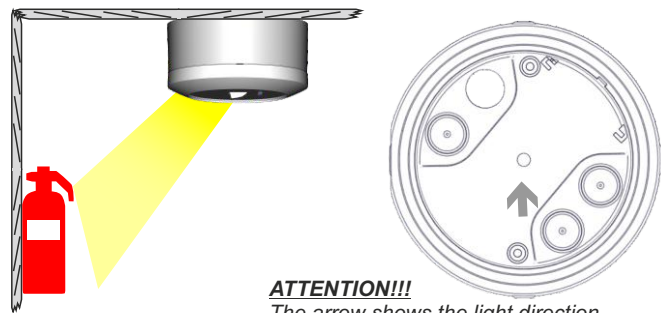

ATTENTION!!!
The arrow shows the light direction.

According to EN 1838 First aid post, fire fighting equipment and call point shall be provided by 5 lux illuminance. For the purpose of this clause "near" is normally considered to be within 2m measured horizontally.

Mount the luminaire according to the spacing tables, as shown below.

Spacing table, 5 Lux for GR-288

Mounting height (m)	1.64	1.83
2.0	1.64	1.83
2.5	1.89	2.27
3.0	2.01	2.57
3.5	1.95	2.66
4.0	x	x

Installation Instructions

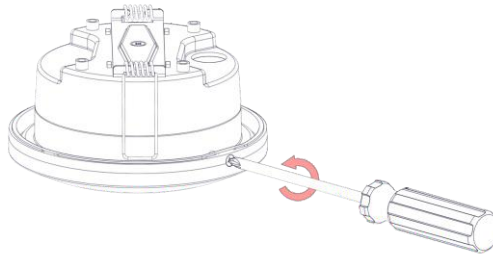

Untighten the screw and pull up the reflector.

1

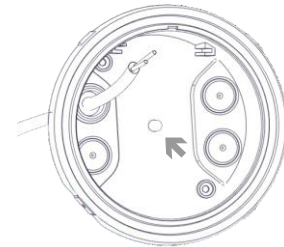

Power Connection

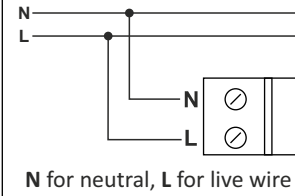

Install the included gasket in to the cable entry hole (verify that is not deformed). Make a hole in the center by using a small screwdriver. Pass the round cable through the gasket. Detach the power terminal, connect the wires as shown in the picture and attach the power terminal (10A max). Supply voltage polarity is irrelevant. **Always use in any case round mains cable, with a diameter of 5-10mm (H05RN-F type 2x1mm² or any other type, at least equal to its mechanical and electrical properties). ATTENTION!! The cable must not be deformed in any way (This requirement is important to ensure the IP rating).**

2

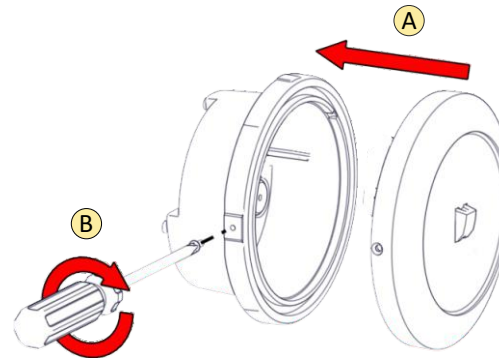

Refit the reflector (mind the correct orientation), tighten the screw securely and the luminaire is ready for mounting.

3

Suspended Ceiling

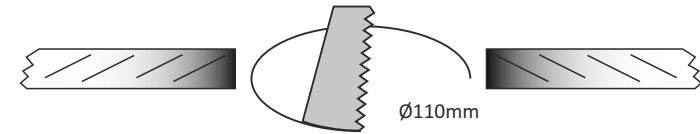

Open a hole in the false ceiling. (Required opening $\varnothing 110\text{mm}$)

1

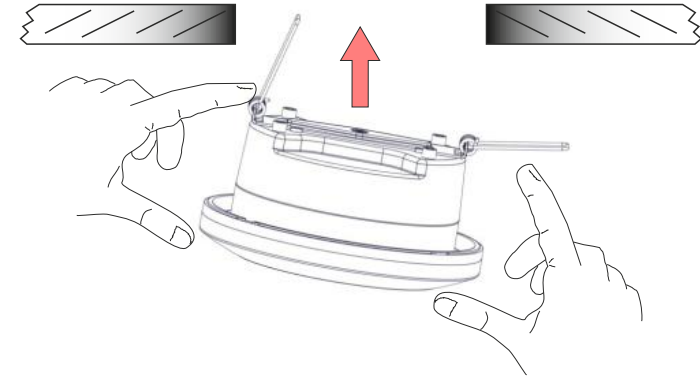

Bend the springs, to get into the hole of the suspended ceiling

2

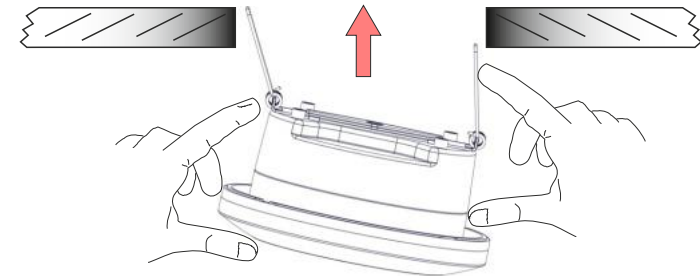

Continue to push upwards until the lamp locks.

3

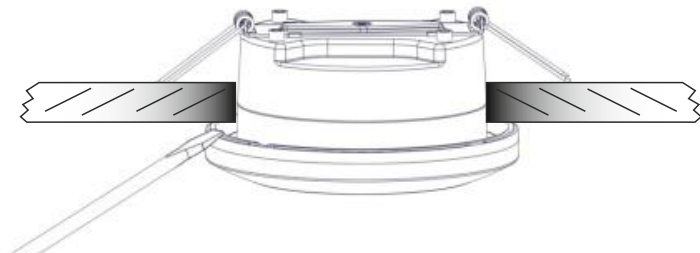

If you want to pull off the device, put a flat blade screwdriver, between the device and the ceiling.