

Dip Switch Maintained/Non Maintained Operation

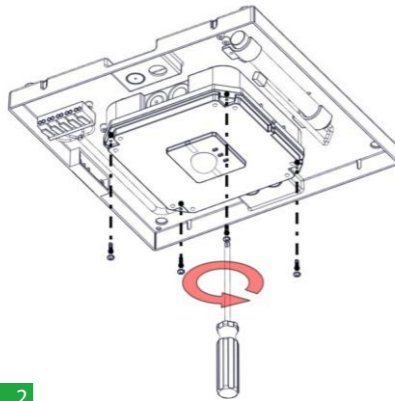
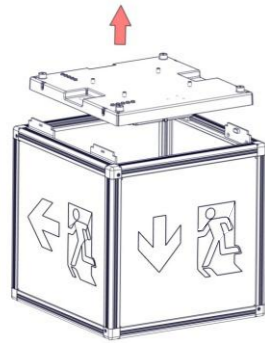

1

2

Dip Switch (DS1) Settings



1h 3h 8h

(default position)

3

Autonomy duration selection

The user can select one of the 3 available minimum autonomy durations: 1 hour, 3 hours and 8 hours. The selection must be done while the luminaire is disconnected from AC and battery supplies. The selection is achieved through Switches 1 & 2 of DS1.

Technical label installation

Two additional labels are included in the package, one for 1 hour duration (60) and one for 8 hours duration (480). Depending on the selected duration, the installer must cover the default 3 hours (180) printing with one that has the required duration. Please take notice of the orientation of the label.

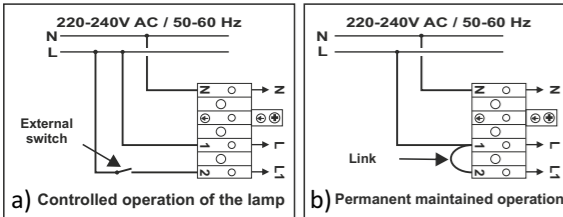

4

Connect the mains cable to the respective terminal block.

a) L for live wire, N for neutral, ⊕ for ground and L1 for maintained operation. The L1 wire can be connected to an external switch to control the maintained or non maintained operation of the luminaire.

b) For permanent maintained operation use two wires to power the luminaire, N for neutral and L for live wire, and link the L and L1.

Battery Replacement

It can be done only by a competent person and after the mains interruption.

1. Remove the top cover (Step 1 of hanging or ceiling installation).
2. Unscrew the 2 screws that hold the battery to its base.
4. Remove the old battery and place a new one of the same type and characteristics.
3. Replace the removed parts.

NOTE: LED= Light Emitting Diode

LABELING EXPLANATION:

X: Self contained

1: Maintained operation (*)

A: Including test device

E: With non-replacable lamp(s) and/or battery

F: Automatic test gear complying with IEC 61347-2-7 denoted EL-T

G: Internally illuminated safety sign

60: 1 hour duration

180: 3 hours duration

480: 8 hours duration

X 1 A E F G 180

(*) **Maintained operation:** The luminaire lights its illumination source, when it is powered by the mains power supply or not.

Non Maintained operation: The luminaire lights its illumination source, only in mains power supply's failure.

ATTENTION!!!

The light source of this luminaire is not user replaceable when the light source reaches its end of life the whole luminaire shall be replaced.

4

923415003_09_003

Technical Characteristics

GR-415/1PL			
OPERATION VOLTAGE	220-240V AC / 50-60Hz		
MAXIMUM POWER CONSUMPTION	6.4W / 6.6VA		
MAXIMUM SUPPLY CURRENT	29 mA		
U-OUT	33V		
Prated	1h: 2.2W	3h: 1.5W	8h: 0.5W
Irated	1h: 200 mA	3h: 141mA	8h: 46mA
MAX OPEN CIRCUIT VOLTAGE	33V		
WIRE CROSS SECTION	0.5mm ² - 2.5mm ²		
MINIMUM POWER FACTOR	0.91		
BATTERY (Ni-MH)	4.8V/2Ah		
INSULATION BETWEEN SUPPLY & CONTROL TERMINALS	Basic insulation		
INSULATION BETWEEN SUPPLY & BATTERY CIRCUIT	Basic insulation		
BATTERY PROTECTION	Deep discharge and overcharge protection / the control gear will recharge the battery normally after the test of 22.3		
MINIMUM DURATION	1 hour	3 hours	8 hours
LIGHT SOURCE LUMINOUS FLUX (MAINS / EMERGENCY)	370/370lm	370/270lm	370/100lm
MIN MAX. DISCHARGE CURRENT	438-700mA	310-490mA	115-189mA
MIN MAX. DISCHARGE VOLTAGE	4-6V		
MIN MAX. CHARGE CURRENT	190-210mA		
TRICKLE CHARGE VOLTAGE/CURRENT	5.8V/70mA		
MAX CHARGE VOLTAGE	6V		
INDICATIONS/CONTROLS	LED Charge, Lamp Fault LED, Battery Fault LED/Test BUTTON		
CHARGE TIME	16h		
LIGHT SOURCE	16 power LEDs		
DEGREES OF COVER PROTECTION	IP40		
PRODUCED IN ACCORDANCE WITH	EN 60598-1, EN 60598-2-22, EN 55015, EN 61547, EN 61000-3-2, EN 61000-3-3		
OPERATION TEMPERATURE RANGE	5 to 40 °C		
CONTROL GEAR MAX.TEMPERATURE: tc	56 °C at PSU1		
RELATIVE HUMIDITY	Up to 95%		
CONSTRUCTION MATERIAL	Aluminium, ABS/PC, PC, Acrylic Plate		
EXTERNAL DIMENSION (L x W x H)	310 x 310 x 330 mm		
WEIGHT	2800gr.		
GUARANTEE	3 years (1 year for the battery)		
CONTROL GEAR WITH AUTOMATIC TEST FUNCTION	EL-T		

LED Characteristics

GR-415/1PL			
MANUFACTURER	Olympia Electronics S.A.		
MODEL NUMBER	0201205		
VOLTAGE RANGE	10.2-11V DC		
NOMINAL POWER	1h:2.2W	3h:1.5W	8h:0.5W
CONNECTIONS	Built-in main board		
TEMPERATURE (tc)	55 °C max. across the board		

Warranty

Olympia Electronics guarantees the quality, condition and operation of the goods. The period of warranty is specified in the official catalogue of Olympia Electronics and also in the technical leaflet, which accompanies each product. This warranty ceases to exist if the buyer does not follow the technical instructions included in official documents given by Olympia Electronics or if the buyer modifies the goods provided or has any repairs or re-setting done by a third party, unless Olympia Electronics has fully agreed to them in writing. Products that have been damaged can be returned to the premises of our company for repair or replacement, as long as the warranty period is valid.

Olympia Electronics reserves the right to repair or to replace the returned goods and to or not charge the buyer depending on the reason of deflection. Olympia Electronics reserves the right to charge or not the buyer the transportation cost.



72nd km. O.N.R. Thessaloniki-Katerini
P.C. 60300 P.O. Box 06 Eginio Pierias Greece

www.olympia-electronics.com
info@olympia-electronics.gr

5



GR-415/1PL

SELF-TESTING MAINTAINED/NON-MAINTAINED EMERGENCY LUMINAIRE SIGN



Thank you for your trust in our products
Olympia Electronics - European manufacturer

923415003_09_003

Package Contents

- 1 Luminaire (Housing)
- 1 Mounting accessories
- 1 Set of 5 pictograms (U, D, R, L, B)
- 4 Acrylic Plates
- 1 Manual

General

These luminaires are used indoors (ta 40°C) where emergency light is needed. Each luminaire must be permanently connected to mains power supply. In normal operation the battery is charging. In case of a mains power supply failure the luminaire will light the led strip automatically in emergency mode (powered by its battery). When the mains power supply is restored the device turns to normal operation.

Manual Operational Test
This test can be done by pushing the test button. The light source and the emergency circuit of the device are monitored. The manual test can be conducted only if the main power supply and the battery is connected. During this test the Lamp Fault indication LED is blinking. The test will not be conducted if the battery does not have adequate charge.

Manual Autonomy Test
A duration test can be conducted by pushing the button steadily for 5 to 10 seconds. In order to be performed, the mains power supply should be connected and battery should be fully charged. The luminaire enters emergency mode, the charge LED is turned OFF and the Battery Fault led starts blinking. This test lasts for the stated duration of the luminaire. If at the end of the test the autonomy is lower than the nominal, the Battery Fault LED will lit and battery needs to be replaced. If the result of the test is good then the luminaire enters charging mode and the Charge led starts blinking until the battery is fully charged.

Automatic Operational Test
It is conducted automatically every 15 days. In order to be performed, the mains power supply and the battery should be connected. The test includes all features of Manual Operational Test.

Automatic Autonomy Test
The Automatic Autonomy Test is conducted every 6 months and measures the device's back up operation and emergency duration. If the battery is not fully charged, the test is postponed until the battery is completely charged. This test includes all functions of the Manual Autonomy Test.

Battery Cut-off
The luminaire enters this mode when the mains power supply fails and battery has lost its energy. During this operation, the battery consumption is negligible, in order to be protected from deep discharge.

Back up operation
The autonomy duration of battery during emergency mode is at least the one that is stated in the list of the technical characteristics. During emergency mode, an operational test is also performed.

Resetting errors
Push the test button for more than 10 seconds, to delete all the LED indicated errors. Then the device enters regular operation mode.

- ATTENTION!!!**
- Operations for installation, maintenance or testing must be done by authorized personnel only. Always use in any case round mains cable, with a diameter of 5-10mm (H05RN-F type 2x1mm²) or any other type, at least equal to it's mechanical and electrical properties).
 - The device must be connected to the mains power supply through a fuse that is dependent on the total line's power load.
 - In case of battery replacement, it must be replaced by the same type, by the manufacturer or a competent person.
 - In case of inactive use for a period greater than 2 months, disconnect the battery by pulling out the battery's connector.
 - The control gear within this luminaire is a built in control gear which relies on the luminaire for protection against electric shock.
 - The control gear is proof against supply voltage polarity reversal.
 - This control gear has mains connected primary windings.
 - It is not allowed to discard batteries into common trash bins, they must be discarded only in battery recycling points. Do not incinerate.

- Connectors**
- CN1: Power connector
 - CN2: Non user connector
 - CN5: Non user connector
 - CN11: Non user connector
 - CN13: Non user connector (for battery usage)
 - CN15: Indication LEDs connector

Indications LED Status

BATT. FAULT (yellow)	LAMP FAULT (red)	CHARGE (green)	Description
⊗	⊗	●	Charging
∅	∅	●	Fully charged
∅	∅	○	Battery fault or emergency mode
∅	●	∅	Operational test
∅	●	∅	Light source fault
●	∅	∅	Autonomy test
●	∅	∅	Duration fault

Note:

●	Permanently ON
●	Blink
○	Off
∅	Indifferent

Installation Methods

The luminaire can be installed in 2 different ways. It can be installed either at the ceiling or hanging with eye bolts. All accessories are including in the package.

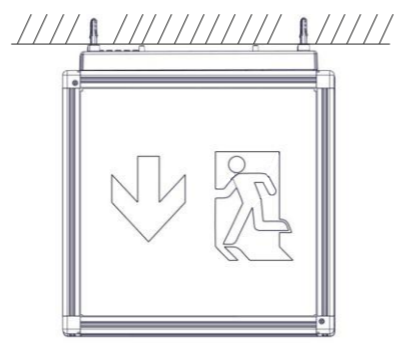

A Ceiling mounting

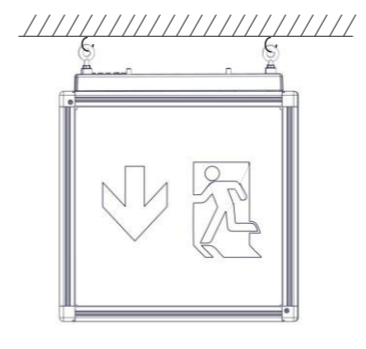

B Hanging installation with hooks

Installation Instructions

Changing Pictogram

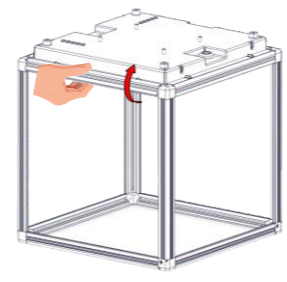

Place the appropriate pictograms according to the position of the luminaire. Firstly, remove the retaining plastic clip.

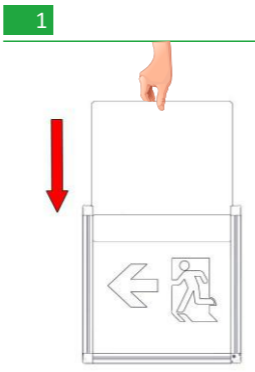

Remove the protective films from both sides of the acrylic plate and install it in front of the pictogram. Mind the orientation of the acrylic plate.

Ceiling Mounting

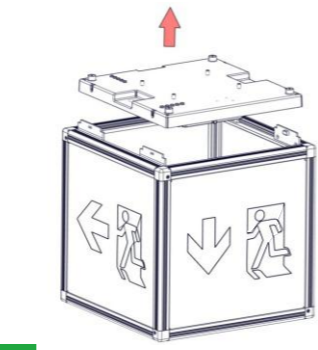

1

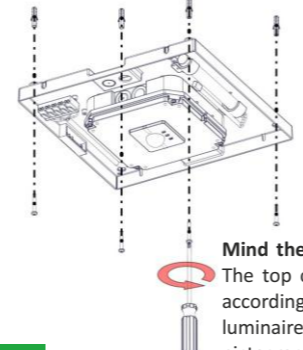

2

Mind the orientation of placement!!
The top placement is achieved according to the bottom part of the luminaire and the already installed pictograms.

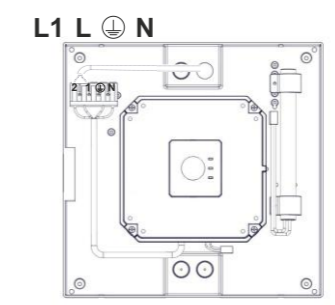

Make a hole in the center of the rubber gasket by using a small screwdriver. Pass the round cable through the rubber gasket and install the gasket in the appropriate hole. Connect the mains cable to the respective terminal block: L for live wire, N for neutral, ⊕ for ground and L1 for maintained operation. Install the included tie (if needed) to fasten securely the power cables. Power supply cables cross section should be 0.8 – 3 mm².

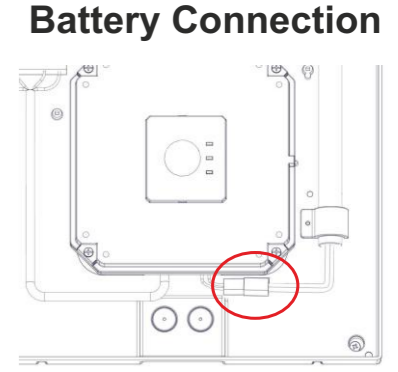

Battery Connection

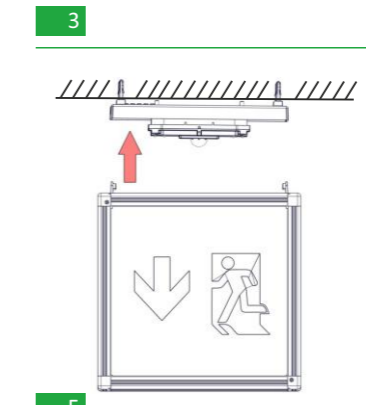

3

Hanging Installation

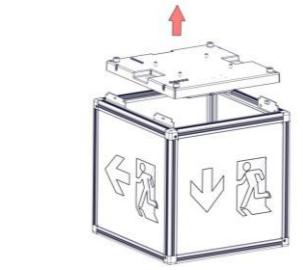

1

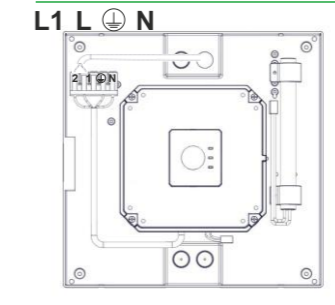

Make a hole in the center of the rubber gasket by using a small screwdriver. Pass the round cable through the rubber gasket and install the gasket in the appropriate hole. Connect the mains cable to the respective terminal block: L for live wire, N for neutral, ⊕ for ground and L1 for maintained operation. Install the included tie (if needed) to fasten securely the power cables. Power supply cables cross section should be 0.8 – 3 mm².

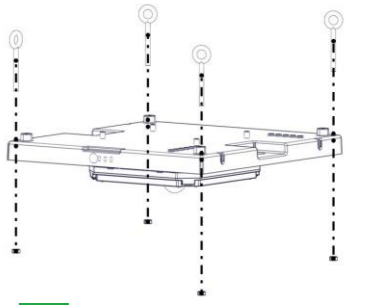

2

Battery Connection

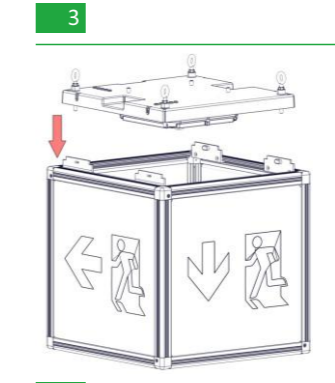

5

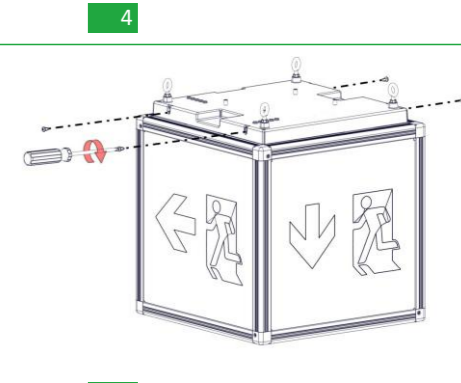

6