

## Battery Replacement

It can be done only by a competent person and after the mains interruption.

1. Follow step 1 of the installation instructions and remove the diffuser.
2. Follow step 2 of the installation instructions and remove the reflector.
3. Remove the old battery and place a new one of the same type and characteristics.
4. Replace the removed parts (previous steps 1 and 2).

**NOTE:** LED= Light Emitting Diode

**LABELING EXPLANATION:**

X: Self contained

1: Maintained operation (\*)

A: Including test device

E: With non-replacable lamp(s) and/or battery

F: Automatic test gear complying with IEC 61347-2-7 denoted EL-T

G: Internally illuminated safety sign

90: 1.5 hour duration

180: 3 hours duration

(\*) **Maintained operation:** The luminaire lights its illumination source, when it is powered by the mains power supply or not.

**Non Maintained operation:** The luminaire lights its illumination source, only in mains power supply's failure.

**NOTE!!** The installer should fill in, on the specification label, the letter **G** if the luminaire is used as a safety sign.

X 1 A E F 1 8 0  
↑  
G

### ATTENTION!!!

The light source of this luminaire is not replaceable when the light source reaches its end of life the whole luminaire shall be replaced.



**CAUTION : Do not view directly with bare eyes.**

## Technical Characteristics

|  | SLL-501   | SLL-503  |
|--|---|----------|
| OPERATION VOLTAGE                              | 220-240V AC / 50-60Hz   |          |
| MAXIMUM POWER CONSUMPTION                      | 7.8W / 8.2VA  |          |
| SUPPLY CURRENT                                 | 38mA  |          |
| U-OUT  | 25V   |          |
| Prated   | 2.7W  |          |
| Irated   | 185mA   |          |
| MAX OPEN CIRCUIT VOLTAGE                       | 25V   |          |
| WIRE CROSS SECTION                             | 0.5mm <sup>2</sup> - 2.5mm <sup>2</sup>   |          |
| MINIMUM POWER FACTOR                           | 0.89  |          |
| BATTERY (Ni-Cd)                                | 4.8V/1.5Ah  | 4.8V/3Ah |
| INSULATION BETWEEN SUPPLY & CONTROL TERMINALS  | Basic insulation  |          |
| INSULATION BETWEEN SUPPLY & BATTERY CIRCUIT    | Basic insulation  |          |
| BATTERY PROTECTION                             | Deep discharge and overcharge protection / the control gear will recharge the battery normally after the test of 22.3 |          |
| MIN MAX. DISCHARGE VOLTAGE                     | 4 - 6V  |          |
| MIN MAX. DISCHARGE CURRENT                     | 500 - 730mA   |          |
| MIN MAX. CHARGE CURRENT                        | 240 - 260mA   |          |
| TRICKLE CHARGE VOLTAGE/CURRENT                 | 5.7V / 30mA   |          |
| MAX CHARGE VOLTAGE                             | 6V  |          |
| INDICATIONS                                    | LED Charge, Lamp Fault LED, Battery Fault LED   |          |
| CHARGE TIME                                    | 24 hours  |          |
| MINIMUM DURATION                               | 1.5 hour  | 3 hours  |
| LIGHT SOURCE                                   | 30 white LEDs   |          |
| LIGHT SOURCE LUMINOUS FLUX (MAINS / EMERGENCY) | 500lm / 500lm   |          |
| DEGREES OF COVER PROTECTION                    | IP40  |          |
| PRODUCED IN ACCORDANCE WITH                    | EN 60598-1, EN 60598-2-22, EN 55015, EN 61547, EN 61000-3-2, EN 61000-3-3   |          |
| VIEWING DISTANCE (as safety sign)              | 30m   |          |
| OPERATION TEMPERATURE RANGE                    | 5 to 40 °C  |          |
| CONTROL GEAR MAX.TEMPERATURE: tc               | 74 °C at Z3   |          |
| RELATIVE HUMIDITY                              | Up to 95%   |          |
| CONSTRUCTION MATERIAL                          | ABS/PC, PC  |          |
| EXTERNAL DIMENSION (L x W x H)                 | 322 x 162 x 58 mm   |          |
| WEIGHT   | 969gr.  | 1061gr.  |
| GUARANTEE                                      | 3 years (1 year for the battery)  |          |
| CONTROL GEAR WITH AUTOMATIC TEST FUNCTION      | <b>EL-T</b>   |          |

## LED Characteristics

|                  | SLL-501  | SLL-503 |
|------------------|--|---------|
| MANUFACTURER     | Olympia Electronics S.A.                         |         |
| MODEL NUMBER     | 1603195  |         |
| VOLTAGE RANGE    | 13.3-14.3V DC                                    |         |
| NOMINAL POWER    | 2.7W   |         |
| CONNECTIONS      | Fixed connection between main pcb and led module |         |
| TEMPERATURE (tc) | 60 °C max. across the board                      |         |

## Warranty

Olympia Electronics guarantees the quality, condition and operation of the goods. The period of warranty is specified in the official catalogue of Olympia Electronics and also in the technical leaflet, which accompanies each product. This warranty ceases to exist if the buyer does not follow the technical instructions included in official documents given by Olympia Electronics or if the buyer modifies the goods provided or has any repairs or re-setting done by a third party, unless Olympia Electronics has fully agreed to them in writing. Products that have been damaged can be returned to the premises of our company for repair or replacement, as long as the warranty period is valid.

Olympia Electronics reserves the right to repair or to replace the returned goods and to or not charge the buyer depending on the reason of defection. Olympia Electronics reserves the right to charge or not the buyer the transportation cost.



72nd km. O.N.R. Thessaloniki-Katerini  
P.C. 60300 P.O. Box 06 Eginio Pierias Greece  
[www.olympia-electronics.gr](http://www.olympia-electronics.gr)  
[info@olympia-electronics.gr](mailto:info@olympia-electronics.gr)



## SLL-501 & SLL-503

**SELFTESTING  
MAINTAINED/NON MAINTAINED  
EMERGENCY LUMINAIRES**



Thank you for your trust in our products  
Olympia Electronics - European manufacturer

## Package Contents

|   |                              |
|---|------------------------------|
| 1 | Luminaire                    |
| 1 | Set of Pictograms            |
| 1 | Surface mounting accessories |
| 1 | Decorative rim               |
| 1 | Recess mounting accessories  |
| 1 | Manual                       |

## General

These devices are used indoors (ta 40°C) in places where emergency light is needed. Each device must be permanently connected to mains power supply. In normal operation the battery is charging. In case of a mains power supply failure, the device enters emergency mode and the illumination LED turns on. When the mains power supply is restored the device turns to normal operation.

### Battery Charging

The battery charging is completely controlled by microprocessor and is protected from complete discharge and overcharge.

### Battery Cut-off

The luminaire enters in this mode when the mains power supply fails and battery has lost its energy. During this mode the luminaire enters the idle state and battery consumption is negligible, in order to be protected from deep discharge.

### Automatic Operational Test

This test is conducted automatically every 15 days and lasts 3 seconds. In order to be performed, the mains power supply and the battery should be connected. The light source and the emergency circuit of the device are tested.

### Automatic Autonomy Test

The Automatic Autonomy Test tests the device's back up operation and emergency duration. This test is conducted automatically every 6 months and its duration is the stated autonomy duration of the luminaire. In order to be performed, the mains power supply should be connected and the battery must be fully charged. If the battery is not fully charged, the test is postponed until the battery is completely charged. If during this test, the autonomy is less than nominal then the battery fault LED will permanently be on and the battery must be replaced.

### Back Up Operation

The autonomy duration of battery during emergency mode must be at least as the one stated in the list of the technical characteristics. During emergency mode, a light source test is also performed.

### ATTENTION!!!

- Operations for installation, maintenance or testing must be done by authorized personnel only.
- The device must be connected to the mains power supply through a fuse that is dependent on the total line's power load.
- In case of battery replacement, it must be replaced by the same type, by the manufacturer or a competent person.
- In case of inactive use for a period greater than 2 months, disconnect the battery by pulling out the battery's connector.
- The control gear within this luminaire is a built in control gear which relies on the luminaire for protection against electric shock.
- The control gear is proof against supply voltage polarity reversal.
- This control gear has mains connected primary windings.
- It is not allowed to discard batteries into common trash bins, they must be discarded only in battery recycling points. Do not incinerate.**

### Connectors

- KL1:** Power connector  
**KL2:** Non user terminal  
**CN4:** Battery connector  
**CN5:** LED connector  
**CN6:** Non user connector  
**CN7:** Non user terminal

## Indications LED Status

| CHARGE<br>(green) | LAMP<br>FAULT<br>(red) | BATT.<br>FAULT<br>(yellow) | Description                     |
|-------------------|------------------------|----------------------------|---------------------------------|
|                   |                        |                            | Charging                        |
|                   |                        |                            | Fully charged                   |
|                   |                        |                            | Battery fault or emergency mode |
|                   |                        |                            | Operational test                |
|                   |                        |                            | Light source fault              |
|                   |                        |                            | Autonomy test                   |
|                   |                        |                            | Duration fault                  |

### Note:

|  |                |
|--|----------------|
|  | Permanently ON |
|  | Blink          |
|  | Off            |
|  | Indifferent    |

## Installation Instructions

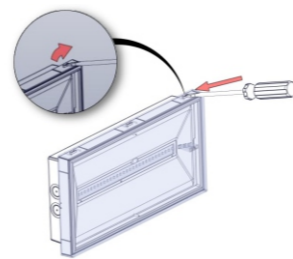

1

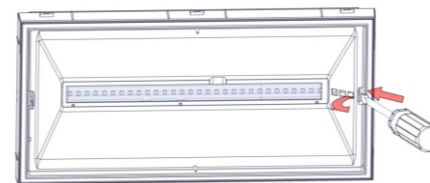

2

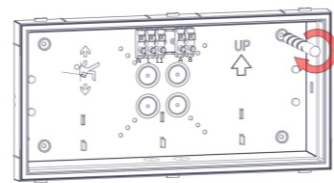

3

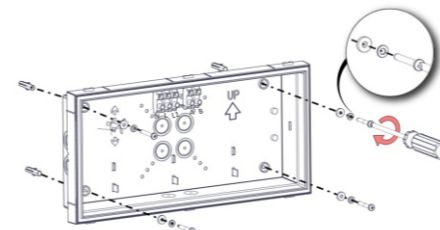

4

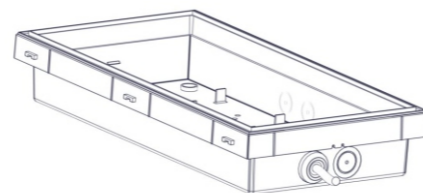

5

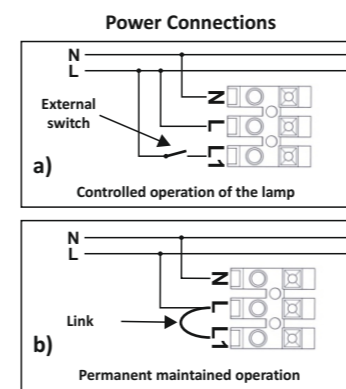

N for neutral, L for live wire and L1 for the maintained operation.

6

Always use in any case round mains cable, with a diameter of 5-10mm (H05RN-F type 2x1mm<sup>2</sup> or any other type, at least equal to it's mechanical and electrical properties). **ATTENTION!! The cable must not be deformed in any way (This requirement is important to ensure the IP rating).**

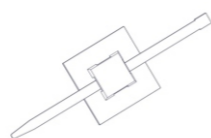

Install the included tie (if needed) to fasten securely the power cables.

7

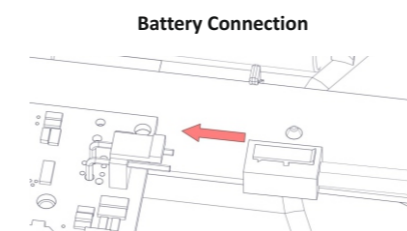

8

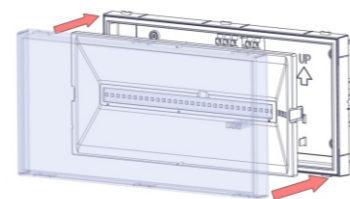

9

This unit has replaceable batteries and contain replaceable address module that can be replaced or changed by the manufacturer or a competent person.

## Commissioning

- After installation, a 24 hours charging cycle must be completed, in order to achieve the nominal autonomy.
- During commissioning of the luminaire write the commissioning date on the battery.
- When power is applied to the unit inspect that the CHARGE indicator is either blinking or steady, all other indicators are OFF and that the led lamp is lit (maintained operation) or OFF (non-maintained operation)
- A full duration test should be conducted after verifying that the CHARGE indicator is continuously ON. Test is initiated by isolating the mains power supply. Verify that the LED lamp is lit during the test period for at least the stated duration.

## Pictogram Installation

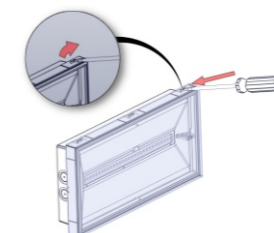

1

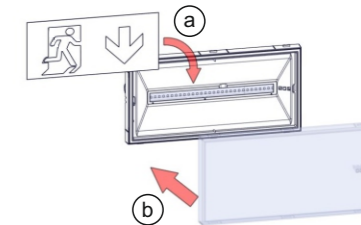

2

## Mounting Methods

Sky Line luminaires can be surface mounted on walls or ceilings. For these mounted installations, special accessories are included.

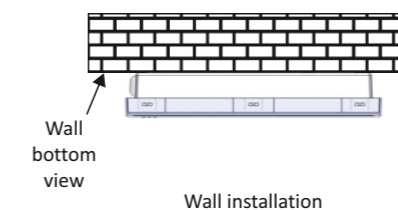

Wall installation

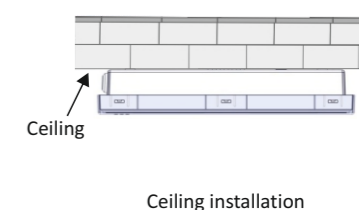

Ceiling installation

## Extra Mounting and Marking Methods \*

### Suspended installation with A-1000 accessory

The luminaire can be installed in a suspended ceiling. For more information refer to the manual of A-1000.

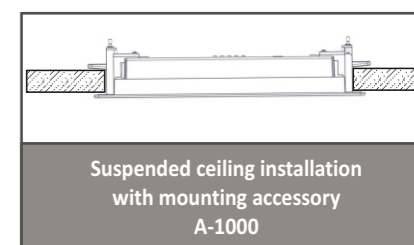

Suspended ceiling installation with mounting accessory A-1000

\* **ATTENTION!!! The below markings can be done after request of the necessary accessories!!**

A marking panel (SP-1000) can be installed on the luminaire pointing the desired direction.

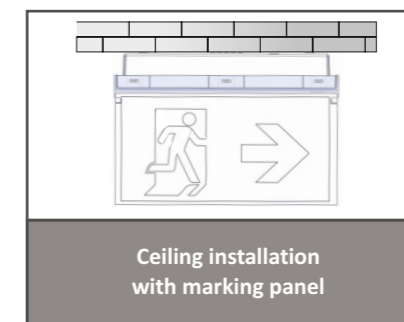

Ceiling installation with marking panel

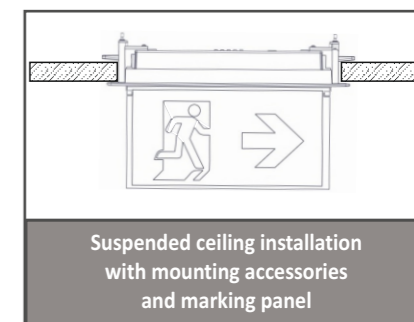

Suspended ceiling installation with mounting accessories and marking panel!