

“BAU LIGHT” SERIES ADDRESSABLE LUMINARIES FOR GR-8600 CBS



TECHNICAL CHARACTERISTICS (for LED MODULE Specifications see page 1)

	GR-750/CBS/24V/ADR/HP/LL	GR-751/CBS/24V/ADR/LP/LL	GR-752/CBS/24V/ADR/HP/HL	GR-753/CBS/24V/ADR/LP/HL
Mains voltage	18-30V DC			
Maximum power consumption	1.5W		2.5W	
Light source intensity	200lm		350lm	
Degrees of cover protection	IP 54			
Produced in accordance with	EN 60598-1, EN 60598-2-22, EN 55015, EN 61547			
Operation temperature range	-30 to 50 °C			
Relative humidity	up to 95%			
Viewing distance	*15m, **17m	15m	*15m, **17m	15m
Construction materials	ABS/PC, PC			
External dimensions	358 x 125 x 88 mm	358 x 85 x 88 mm	358 x 125 x 88 mm	358 x 85 x 88 mm
Typical weight	579 gr.	551 gr.	579 gr.	551 gr.
Guarantee	3 years			

Thank you for your trust in our products Olympia Electronics - European manufacturer

GENERAL

- Operations for installation, maintainance or testing must be done by authorized personnel only.
- The device, must be connected **only** to the GR-8600 panel via its ADR line.
- The user must set the address before installation. To address the device see on page 3.

ADDRESS OPERATION

For address operations refer to the installation manual of the panel. Please see manual of CBS panel GR-8600 for maximum number of luminaries that can be interconnected.

*15m: When the luminary is installed on a wall.
**17m: When luminary is installed on the ceiling.

LED MODULE CHARACTERISTICS

	GR-750/CBS/24V/ADR/HP/LL	GR-751/CBS/24V/ADR/LP/LL	GR-752/CBS/24V/ADR/HP/HL	GR-753/CBS/24V/ADR/LP/HL
Manufacturer	Olympia Electronics S.A			
Model Number	2505195			
Voltage Range	12-13.5V DC		12-14V DC	
Nominal Power	1.1W		2.4W	
Connections	Non-reversible connection between main pcb and led module			
Temperature (tc)	35 °C max. across the board		45 °C max. across the board	



The light source contained in this luminary shall only be replaced by the manufacturer, or his agent, or a similar qualified person.

NOTE! The light source is non-user replaceable.

NOTE: LED= Light Emitting Diode
LABELING EXPLANATION:
Z: Central supply
1: Maintained (*)
C: Including inhibiting mode
G: Internally illuminated safety sign

NOTE!! The installer should fill in, on the specification label, the letter **G** if the luminaire is used as a safety sign.

↓
Z 1 C

(*) Maintained operation: The luminaire lights its illumination source, when it is powered by the mains power supply or not.

Non Maintained operation: The luminaire lights its illumination source, only in power supply's failure.

Luminary Installation Procedure

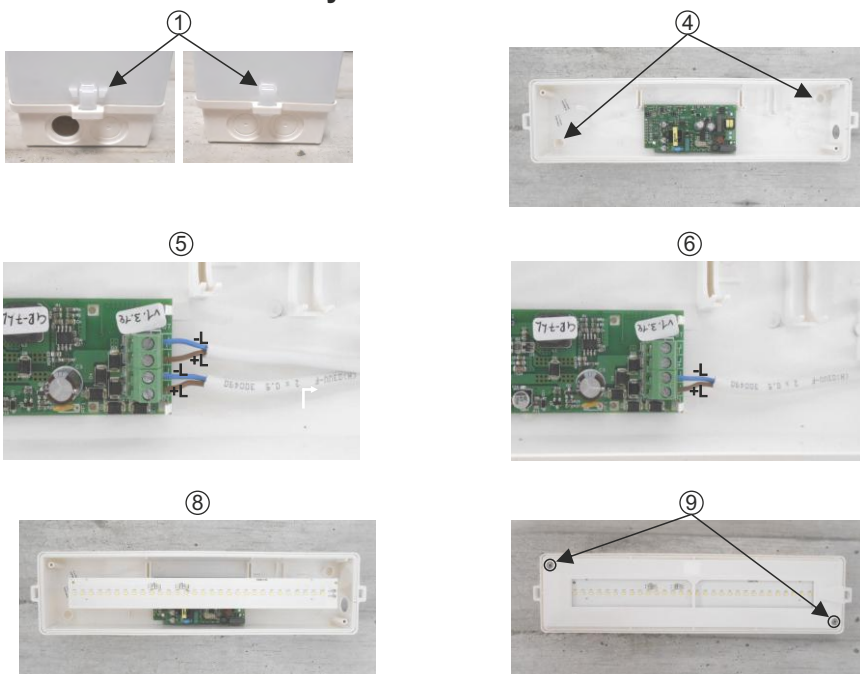

- ① Place a flat blade screwdriver to the plastic hook and pull up gently to release the diffuser.
- ② Remove the reflector.
- ③ Remove the led strip.
- ④ Use the included mounting parts to mount the base plastic.
- ⑤ **Always use round mains cable, with a suitable diameter to fit tightly into the gasket. ATTENTION!! The cable must not be deformed in any way (This requirement is important to ensure the IP rating).** Always refer to GR-8600 manual regarding to the cable's cross section's selection. Install the included gasket into the cable entry hole (*verify that is not deformed*). Make a hole in the center by using a small screwdriver. Pass the communication cables through the hole and connect them as shown on the picture (minding the correct polarity). When there are other luminaries to be connected to the line we recommend to open a second hole to pass the second pair of communication cables.
- ⑥ If the luminary you installed is the last one, connect the cable to one of the two inputs, as shown on the picture (minding the correct polarity).
- ⑦ Address the device through the dipswitch according to the table on page 3.
- ⑧ Refit the led strip minding the connection with the P.C.B.
Warning!! The holes of the led strip must be fit in the projections of the base.
- ⑨ Refit the reflector (mind the correct orientation) and tighten the screws.
- ⑩ Refit the diffuser (mind the correct orientation) and power on the device. (see GR-8600 manual).

Addressing Table

Address	Dipswitch setting	Address	Dipswitch setting	Address	Dipswitch setting	Address	Dipswitch setting
1	ON 1 2 3 4 5 6	11	ON 1 2 3 4 5 6	21	ON 1 2 3 4 5 6	31	ON 1 2 3 4 5 6
2	ON 1 2 3 4 5 6	12	ON 1 2 3 4 5 6	22	ON 1 2 3 4 5 6	32	ON 1 2 3 4 5 6
3	ON 1 2 3 4 5 6	13	ON 1 2 3 4 5 6	23	ON 1 2 3 4 5 6		
4	ON 1 2 3 4 5 6	14	ON 1 2 3 4 5 6	24	ON 1 2 3 4 5 6		
5	ON 1 2 3 4 5 6	15	ON 1 2 3 4 5 6	25	ON 1 2 3 4 5 6		
6	ON 1 2 3 4 5 6	16	ON 1 2 3 4 5 6	26	ON 1 2 3 4 5 6		
7	ON 1 2 3 4 5 6	17	ON 1 2 3 4 5 6	27	ON 1 2 3 4 5 6		
8	ON 1 2 3 4 5 6	18	ON 1 2 3 4 5 6	28	ON 1 2 3 4 5 6		
9	ON 1 2 3 4 5 6	19	ON 1 2 3 4 5 6	29	ON 1 2 3 4 5 6		
10	ON 1 2 3 4 5 6	20	ON 1 2 3 4 5 6	30	ON 1 2 3 4 5 6		

WARRANTY

Olympia Electronics guarantees the quality, condition and operation of the goods. The period of warranty is specified in the official catalogue of Olympia Electronics and also in the technical leaflet, which accompanies each product. This warranty ceases to exist if the buyer does not follow the technical instructions included in official documents given by Olympia Electronics or if the buyer modifies the goods provided or has any repairs or re-setting done by a third party, unless Olympia Electronics has fully agreed to them in writing. Products that have been damaged can be returned to the premises of our company for repair or replacement, as long as the warranty period is valid.

Olympia Electronics reserves the right to repair or to replace the returned goods and to or not charge the buyer depending on the reason of defection. Olympia Electronics reserves the right to charge or not the buyer the transportation cost.

HEAD OFFICE

72nd km. O.N.R. Thessaloniki-Katerini
P.C. 60300 P.O. Box 06 Eginio Pierias Greece

www.olympia-electronics.gr

info@olympia-electronics.gr