

WATERPROOF CBS LUMINAIRES WITH LEDs



TECHNICAL CHARACTERISTICS

	GR-1926/15L/24V DC	GR-1926/30L/24V DC
OPERATION VOLTAGE	15-30VDC	
MAXIMUM POWER CONSUMPTION	1W	2W
ILLUMINATION SOURCE	15 White LED	30 White LED
ILLUMINATION	125lm	255lm
DEGREES OF COVER PROTECTION	IP65	
PRODUCED IN ACCORDANCE WITH	EN 60598-1, EN 60598-2-22, EN 55015, EN 61547	
OPERATION TEMPERATURE RANGE	-20 to 50 °C	
RELATIVE HUMIDITY	Up to 95%	
CONSTRUCTION MATERIALS	Bayblend FR3010, transparent polycarbonate	
EXTERNAL DIMENSIONS	313 x 118 x 66 mm	
TYPICAL WEIGHT	500gr.	
GUARANTEE	3 years	

Thank you for your trust in our products
Olympia Electronics - European manufacturer

GENERAL

These luminaires are used in places where emergency luminaires are needed. Each luminaire must be permanently connected to Central Battery System.

INSTALLATION

To install the luminaire follow the installation instructions below.

ATTENTION!!!

1. Operations for installation, maintenance or testing must be done by authorized personnel only.

LED MODULE CHARACTERISTICS

	GR-1926/15L/24V DC	GR-1926/30L/24V DC
Manufacturer	Olympia Electronics S.A.	
Model Number	2402159/15L	2402159/30L
Voltage Range	8.5-10.5 V DC	
Nominal Power	980mW	2W
Connections	Non reversible connection between main pcb and led module	
Temperature (tc)	47 °C max. across the board	



The light source contained in this luminaire shall only be replaced by the manufacturer, or his agent, or a similar qualified person.

NOTE! The light source is non-user replaceable.

NOTE: LED= Light Emitting Diode

LABELING EXPLANATION:

Z: Central Supply

1: Maintained

G: Internally illuminated safety sign

Note!! The installer should fill in, on the specification label, the letter **G** if the luminaire is used as a safety sign.

↓
Z 1 G

(*) Maintained operation: The luminaire lights its illumination source, when it is powered by the CBS panel, through an appropriate configured maintained zone.

Non Maintained operation: The luminaire lights its illumination source, powered by the CBS panel only in mains fault.

INSTALLATION INSTRUCTIONS FOR WALL OR CEILING MOUNTING

- ① Unclip the plastic latches with a flat blade screwdriver, unfasten the 2 screws (not all the way, *step 7 B*) and remove the diffuser. Place simultaneously 2 flat blade screwdrivers to the recesses and pull up gently the reflector.
- ② Install the base plastic (with the included mounting screws and plugs). **WARNING!! To preserve the IP rating, fit the screws with the metallic washers and plastic rings which are included.**
- ③ **Always use in any case round mains cable, with external diameter of 5-10mm (H05RN-F type 2x1mm² or any other type, at least equal to it's mechanical and electrical properties).**
ATTENTION!! The cable must not be deformed in any way (This requirement is important to ensure the IP rating). Install the gasket and make a hole in the center by using a small screwdriver. Pass the round cable through the gasket. Install the second included gasket into the unused hole.
- ④ Connect the power cables to the respective terminal block + and - (mind the correct polarity).
- ⑤ Install the included tie to fasten securely the power cables.
- ⑥ Refit the reflector (mind the holes of the indications).
- ⑦ Finally place the diffuser (mind the holes of the indications). **Attention!! First the plastic latches (A) must be secured (click sound) and then fasten the 2 screws (B) (tightening torque 1.2 Nm).**

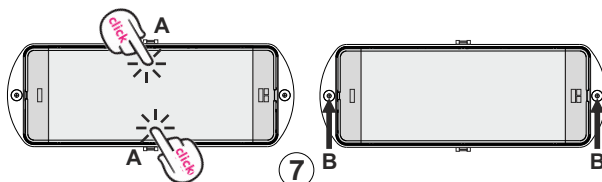
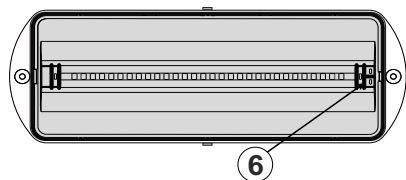
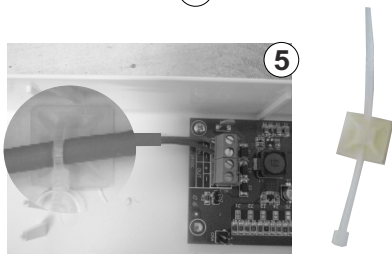
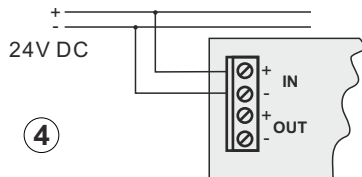
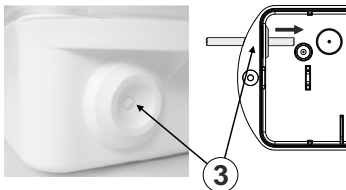
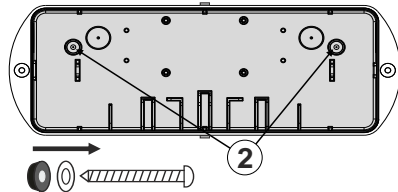
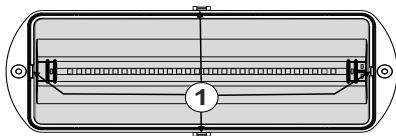

WARRANTY

Olympia Electronics guarantees the quality, condition and operation of the goods. The period of warranty is specified in the official catalogue of Olympia Electronics and also in the technical leaflet, which accompanies each product. This warranty ceases to exist if the buyer does not follow the technical instructions included in official documents given by Olympia Electronics or if the buyer modifies the goods provided or has any repairs or re-setting done by a third party, unless Olympia Electronics has fully agreed to them in writing. Products that have been damaged can be returned to the premises of our company for repair or replacement, as long as the warranty period is valid. Olympia Electronics reserves the right to repair or to replace the returned goods and to or not charge the buyer depending on the reason of defection. Olympia Electronics reserves the right to charge or not the buyer the transportation cost.

HEAD OFFICE

72nd km. O.N.R. Thessaloniki-Katerini
P.C. 60300 P.O. Box 06 Eginio Pierias Greece

www.olympia-electronics.gr

info@olympia-electronics.gr